

Crown copyright and database rights 2023 OS 100019726



Papa Johns, 51a Camden High Street, London, NW1 7JH

Scale = 1:1447.740
20-November-2023

Application to vary a premises licence under the Licensing Act 2003

PLEASE READ THE FOLLOWING INSTRUCTIONS FIRST

Before completing this form please read the guidance notes at the end of the form. If you are completing this form by hand please write legibly in block capitals. In all cases ensure that your answers are inside the boxes and written in black ink. Use additional sheets if necessary.

You may wish to keep a copy of the completed form for your records.

I/We PJ Corp Stores Limited

(Insert name(s) of applicant)

being the premises licence holder, apply to vary a premises licence under section 34 of the Licensing Act 2003 for the premises described in Part 1 below

Premises licence number

PREM-LIC\1545

Part 1 – Premises Details

Postal address of premises or, if none, ordnance survey map reference or description			
Papa John's 51A Camden High Street Camden Town London			
Post town		Postcode	NW1 7JH

Telephone number at premises (if any)	
Non-domestic rateable value of premises	████████

Part 2 – Applicant details

Daytime contact telephone number			
E-mail address (optional)			
Current postal address if different from premises address	████████████████████ ██████████████████ ██████████ ██████████		
Post town		Postcode	████████

Part 3 - Variation

Please tick as appropriate

Do you want the proposed variation to have effect as soon as possible? Yes No

If not, from what date do you want the variation to take effect?

DD		MM		YYYY		
A	S	A	P			

Do you want the proposed variation to have effect in relation to the introduction of the late night levy? (Please see guidance note 1) Yes No

Please describe briefly the nature of the proposed variation (Please see guidance note 2)

1. Extend the hours for licensable activities as follows:

23:00 to 05:00

2. Extend the opening hours as follows:

00:00 to 24:00

3. Add the following condition:

“The premises shall close to the public after 02:00 and will then operate solely as a delivery service until 05:00”.

If your proposed variation would mean that 5,000 or more people are expected to attend the premises at any one time, please state the number expected to attend:

Part 4 Operating Schedule

Please complete those parts of the Operating Schedule below which would be subject to change if this application to vary is successful.

- | Provision of regulated entertainment (Please see guidance note 3) | Please tick all that apply |
|---|-----------------------------------|
| a) plays (if ticking yes, fill in box A) | <input type="checkbox"/> |
| b) films (if ticking yes, fill in box B) | <input type="checkbox"/> |
| c) indoor sporting events (if ticking yes, fill in box C) | <input type="checkbox"/> |
| d) boxing or wrestling entertainment (if ticking yes, fill in box D) | <input type="checkbox"/> |
| e) live music (if ticking yes, fill in box E) | <input type="checkbox"/> |
| f) recorded music (if ticking yes, fill in box F) | <input type="checkbox"/> |
| g) performances of dance (if ticking yes, fill in box G) | <input type="checkbox"/> |
| h) anything of a similar description to that falling within (e), (f) or (g) (if ticking yes, fill in box H) | <input type="checkbox"/> |

Provision of late night refreshment (if ticking yes, fill in box I)

Supply of alcohol (if ticking yes, fill in box J)

In all cases complete boxes K, L and M

A

Plays Standard days and timings (please read guidance note 8)			Will the performance of a play take place <u>indoors or outdoors or both – please tick</u> (please read guidance note 4)	Indoors	<input type="checkbox"/>
				Outdoors	<input type="checkbox"/>
				Both	<input type="checkbox"/>
Day	Start	Finish			
Mon			<u>Please give further details here</u> (please read guidance note 5)		
Tue					
Wed			<u>State any seasonal variations for performing plays</u> (please read guidance note 6)		
Thur					
Fri			<u>Non standard timings. Where you intend to use the premises for the performance of plays at different times to those listed in the column on the left, please list</u> (please read guidance note 7)		
Sat					
Sun					

B

Films Standard days and timings (please read guidance note 8)			<u>Will the exhibition of films take place indoors or outdoors or both – please tick</u> (please read guidance note 4)	Indoors	<input type="checkbox"/>
				Outdoors	<input type="checkbox"/>
				Both	<input type="checkbox"/>
Day	Start	Finish			
Mon			<u>Please give further details here</u> (please read guidance note 5)		
Tue					
Wed			<u>State any seasonal variations for the exhibition of films</u> (please read guidance note 6)		
Thur					
Fri			<u>Non standard timings. Where you intend to use the premises for the exhibition of films at different times to those listed in the column on the left, please list</u> (please read guidance note 7)		
Sat					
Sun					

C

Indoor sporting events Standard days and timings (please read guidance note 8)			<u>Please give further details</u> (please read guidance note 5)
Day	Start	Finish	
Mon			
Tue			<u>State any seasonal variations for indoor sporting events</u> (please read guidance note 6)
Wed			
Thur			<u>Non standard timings. Where you intend to use the premises for indoor sporting events at different times to those listed in the column on the left, please list</u> (please read guidance note 7)
Fri			
Sat			
Sun			

D

Boxing or wrestling entertainments Standard days and timings (please read guidance note 8)			<u>Will the boxing or wrestling entertainment take place indoors or outdoors or both – please tick</u> (please read guidance note 4)	Indoors	<input type="checkbox"/>			
				Outdoors	<input type="checkbox"/>			
				Both	<input type="checkbox"/>			
Day	Start	Finish	<u>Please give further details here</u> (please read guidance note 5)					
Mon								
Tue								
Wed						<u>State any seasonal variations for boxing or wrestling entertainment</u> (please read guidance note 6)		
Thur								
Fri						<u>Non standard timings. Where you intend to use the premises for boxing or wrestling entertainment at different times to those listed in the column on the left, please list</u> (please read guidance note 7)		
Sat								
Sun								

E

Live music Standard days and timings (please read guidance note 8)			Will the performance of live music take place <u>indoors or outdoors or both – please tick</u> (please read guidance note 4)	Indoors	<input type="checkbox"/>
				Outdoors	<input type="checkbox"/>
				Both	<input type="checkbox"/>
Day	Start	Finish			
Mon			<u>Please give further details here</u> (please read guidance note 5)		
Tue					
Wed			<u>State any seasonal variations for the performance of live music</u> (please read guidance note 6)		
Thur					
Fri			<u>Non standard timings. Where you intend to use the premises for the performance of live music at different times to those listed in the column on the left, please list</u> (please read guidance note 7)		
Sat					
Sun					

F

Recorded music Standard days and timings (please read guidance note 8)			Will the playing of recorded music take place <u>indoors or outdoors or both – please tick</u> (please read guidance note 4)	Indoors	<input type="checkbox"/>
				Outdoors	<input type="checkbox"/>
Day	Start	Finish		Both	<input type="checkbox"/>
Mon			<u>Please give further details here</u> (please read guidance note 5)		
Tue			<u>State any seasonal variations for the playing of recorded music</u> (please read guidance note 6)		
Wed			<u>Non standard timings. Where you intend to use the premises for the playing of recorded music at different times to those listed in the column on the left, please list</u> (please read guidance note 7)		
Thur					
Fri					
Sat					
Sun					

G

Performances of dance Standard days and timings (please read guidance note 8)			Will the performance of dance take place <u>indoors or outdoors or both – please tick</u> (please read guidance note 4)	Indoors	<input type="checkbox"/>
Day	Start	Finish		Outdoors	<input type="checkbox"/>
				Both	<input type="checkbox"/>
Mon			<u>Please give further details here</u> (please read guidance note 5)		
Tue					
Wed			<u>State any seasonal variations for the performance of dance</u> (please read guidance note 6)		
Thur					
Fri			<u>Non standard timings. Where you intend to use the premises for the performance of dance at different times to those listed in the column on the left, please list</u> (please read guidance note 7)		
Sat					
Sun					

H

Anything of a similar description to that falling within (e), (f) or (g) Standard days and timings (please read guidance note 8)			Please give a description of the type of entertainment you will be providing		
Day	Start	Finish	<u>Will this entertainment take place indoors or outdoors or both – please tick</u> (please read guidance note 4)	Indoors	<input type="checkbox"/>
Mon				Outdoors	<input type="checkbox"/>
				Both	<input type="checkbox"/>
Tue			<u>Please give further details here</u> (please read guidance note 5)		
Wed					
Thur			<u>State any seasonal variations for entertainment of a similar description to that falling within (e), (f) or (g)</u> (please read guidance note 6)		
Fri					
Sat			<u>Non standard timings. Where you intend to use the premises for the entertainment of a similar description to that falling within (e), (f) or (g) at different times to those listed in the column on the left, please list</u> (please read guidance note 7)		
Sun					

I

Late night refreshment Standard days and timings (please read guidance note 8)			<u>Will the provision of late night refreshment take place indoors or outdoors or both – please tick</u> (please read guidance note 4)	Indoors	<input type="checkbox"/>
Day	Start	Finish		Outdoors	<input type="checkbox"/>
				Both	<input checked="" type="checkbox"/>
Mon	23:00	05:00	<u>Please give further details here</u> (please read guidance note 5)		
Tue	23:00	05:00			
Wed	23:00	05:00	<u>State any seasonal variations for the provision of late night refreshment</u> (please read guidance note 6)		
Thur	23:00	05:00			
Fri	23:00	05:00	<u>Non standard timings. Where you intend to use the premises for the provision of late night refreshment at different times, to those listed in the column on the left, please list</u> (please read guidance note 7)		
Sat	23:00	05:00	If applicable, an additional hour to the standard and non-standard times on the day when British summertime commences.		
Sun	23:00	05:00	From the standard start timing on 31 st December to the standard start time on the 1 st January.		

J

Supply of alcohol Standard days and timings (please read guidance note 8)			Will the supply of alcohol be for consumption – please tick (please read guidance note 9)	On the premises	<input type="checkbox"/>
				Off the premises	<input type="checkbox"/>
				Both	<input type="checkbox"/>
Day	Start	Finish	<u>State any seasonal variations for the supply of alcohol</u> (please read guidance note 6)		
Mon					
Tue					
Wed					
Thur					
Fri					
Sat					
Sun			<u>Non standard timings. Where you intend to use the premises for the supply of alcohol at different times to those listed in the column on the left, please list</u> (please read guidance note 7)		

K

<p>Please highlight any adult entertainment or services, activities, other entertainment or matters ancillary to the use of the premises that may give rise to concern in respect of children (please read guidance note 10).</p> <p>As far as the applicant is aware none of the proposed activities should give rise to concern in respect of children.</p>
--

L

Hours premises are open to the public Standard days and timings (please read guidance note 8)			<u>State any seasonal variations</u> (please read guidance note 6)
Day	Start	Finish	
Mon	00:00	24:00	
Tue	00:00	24:00	
Wed	00:00	24:00	
Thur	00:00	24:00	<u>Non standard timings. Where you intend the premises to be open to the public at different times from those listed in the column on the left, please list</u> (please read guidance note 7) If applicable, an additional hour to the standard and non-standard times on the day when British summertime comences. From the standard start timing on 31 st December to the standard start time on the 1 st January.
Fri	00:00	24:00	
Sat	00:00	24:00	
Sun	00:00	24:00	

Please identify those conditions currently imposed on the licence which you believe could be removed as a consequence of the proposed variation you are seeking.

Please tick as appropriate

- I have enclosed the premises licence
- I have enclosed the relevant part of the premises licence

If you have not ticked one of these boxes, please fill in reasons for not including the licence or part of it below

Reasons why I have not enclosed the premises licence or relevant part of premises licence.

Online application.

M

Describe any additional steps you intend to take to promote the four licensing objectives as a result of the proposed variation:

a) General – all four licensing objectives (b, c, d and e) (please read guidance note 11)

The licensing objectives have been considered taking into account the nature of the premises and the proposed style of operation.

The premises will operate in accordance with all relevant legislation.

The premises will liaise and co-cooperate with the Responsible Authorities.

The existing conditions will remain on the premises licence.

Add the following condition:

“The premises shall close to the public after 02:00 and will then operate solely as a delivery service until 05:00”.

b) The prevention of crime and disorder

See box a) above.

c) Public safety

The premises will operate in accordance with all relevant legislation which promotes the prevention of public safety objective. For example, the Health & Safety and Food Safety legislation

The premises will liaise and co-operate with the Responsible Authorities.

d) The prevention of public nuisance

The premises will operate in accordance with all relevant legislation which promotes the prevention of public nuisance objective. For example, Environmental Protection Act 1990.

Arrangements for the storage and disposal of refuse will not cause a nuisance.

The premises will liaise and co-operate with the Responsible Authorities.

e) The protection of children from harm

See box a) above.

Checklist:

Please tick to indicate agreement

- I have made or enclosed payment of the fee; or
- I have not made or enclosed payment of the fee because this application has been made in relation to the introduction of the late night levy.
- I have sent copies of this application and the plan to responsible authorities and others where applicable.
- I understand that I must now advertise my application.
- I have enclosed the premises licence or relevant part of it or explanation.
- I understand that if I do not comply with the above requirements my application will be rejected.

IT IS AN OFFENCE, UNDER SECTION 158 OF THE LICENSING ACT 2003, TO MAKE A FALSE STATEMENT IN OR IN CONNECTION WITH THIS APPLICATION. THOSE WHO MAKE A FALSE STATEMENT MAY BE LIABLE ON SUMMARY CONVICTION TO A FINE OF ANY AMOUNT.

Part 5 – Signatures (please read guidance note 12)

Signature of applicant (the current premises licence holder) or applicant's solicitor or other duly authorised agent (please read guidance note 13). **If signing on behalf of the applicant, please state in what capacity.**

Signature	
Date	24 August 2023
Capacity	Authorised Agent

Where the premises licence is jointly held, signature of 2nd applicant (the current premises licence holder) or 2nd applicant's solicitor or other authorised agent (please read guidance note 14). **If signing on behalf of the applicant, please state in what capacity.**

Signature	
Date	
Capacity	

Contact name (where not previously given) and address for correspondence associated with this application (please read guidance note 15)			
[REDACTED]			
[REDACTED]			
[REDACTED]			
[REDACTED]			
Post town	[REDACTED]	Post code	[REDACTED]
Telephone number (if any)	[REDACTED]		
If you would prefer us to correspond with you by e-mail, your e-mail address (optional)			
[REDACTED]			

Notes for Guidance

This application cannot be used to vary the licence so as to extend the period for which the licence has effect or to vary substantially the premises to which it relates. If you wish to make that type of change to the premises licence, you should make a new premises licence application under section 17 of the Licensing Act 2003.

1. You do not have to pay a fee if the only purpose of the variation for which you are applying is to avoid becoming liable for the late night levy
2. Describe the premises. For example, the type of premises, its general situation and layout and any other information which could be relevant to the licensing objectives. Where your application includes off-supplies of alcohol and you intend to provide a place of consumption of these off-supplies of alcohol, you must include a description of where the place will be and its proximity to the premises.
3. In terms of specific regulated entertainments please note that:
 - Plays: no licence is required for performances between 08.00 and 23.00 on any day, provided that the audience does not exceed 500.
 - Films: no licence is required for 'not-for-profit' film exhibition held in community premises between 08.00 and 23.00 on any day provided that the audience does not exceed 500 and the organiser (a) gets consent to the screening from a person who is responsible for the premises; and (b) ensures that each such screening abides by age classification ratings.
 - Indoor sporting events: no licence is required for performances between 08.00 and 23.00 on any day, provided that the audience does not exceed 1000.
 - Boxing or Wrestling Entertainment: no licence is required for a contest, exhibition or display of Greco-Roman wrestling, or freestyle wrestling between 08.00 and 23.00 on any day, provided that the audience does not exceed 1000. Combined fighting sports – defined as a contest, exhibition or display which combines boxing or wrestling with one or more martial arts – are licensable as a boxing or wrestling entertainment rather than an indoor sporting event.
 - Live music: no licence permission is required for:
 - a performance of unamplified live music between 08.00 and 23.00 on any day, on any premises.
 - a performance of amplified live music between 08.00 and 23.00 on any day on premises authorised to sell alcohol for consumption on those premises, provided that the audience does not exceed 500.

- a performance of amplified live music between 08.00 and 23.00 on any day, in a workplace that is not licensed to sell alcohol on those premises, provided that the audience does not exceed 500.
 - a performance of amplified live music between 08.00 and 23.00 on any day, in a church hall, village hall, community hall, or other similar community premises, that is not licensed by a premises licence to sell alcohol, provided that (a) the audience does not exceed 500, and (b) the organiser gets consent for the performance from a person who is responsible for the premises.
 - a performance of amplified live music between 08.00 and 23.00 on any day, at the non-residential premises of (i) a local authority, or (ii) a school, or (iii) a hospital, provided that (a) the audience does not exceed 500, and (b) the organiser gets consent for the performance on the relevant premises from: (i) the local authority concerned, or (ii) the school or (iii) the health care provider for the hospital.
 - Recorded Music: no licence permission is required for:
 - any playing of recorded music between 08.00 and 23.00 on any day on premises authorised to sell alcohol for consumption on those premises, provided that the audience does not exceed 500.
 - any playing of recorded music between 08.00 and 23.00 on any day, in a church hall, village hall, community hall, or other similar community premises, that is not licensed by a premises licence to sell alcohol, provided that (a) the audience does not exceed 500, and (b) the organiser gets consent for the performance from a person who is responsible for the premises.
 - any playing of recorded music between 08.00 and 23.00 on any day, at the non-residential premises of (i) a local authority, or (ii) a school, or (iii) a hospital, provided that (a) the audience does not exceed 500, and (b) the organiser gets consent for the performance on the relevant premises from: (i) the local authority concerned, or (ii) the school proprietor or (iii) the health care provider for the hospital.
 - Dance: no licence is required for performances between 08.00 and 23.00 on any day, provided that the audience does not exceed 500. However, a performance which amounts to adult entertainment remains licensable.
 - Cross activity exemptions: no licence is required between 08.00 and 23.00 on any day, with no limit on audience size for:
 - any entertainment taking place on the premises of the local authority where the entertainment is provided by or on behalf of the local authority;
 - any entertainment taking place on the hospital premises of the health care provider where the entertainment is provided by or on behalf of the health care provider;
 - any entertainment taking place on the premises of the school where the entertainment is provided by or on behalf of the school proprietor; and
 - any entertainment (excluding films and a boxing or wrestling entertainment) taking place at a travelling circus, provided that (a) it takes place within a moveable structure that accommodates the audience, and (b) that the travelling circus has not been located on the same site for more than 28 consecutive days.
4. Where taking place in a building or other structure please tick as appropriate (indoors may include a tent).
5. For example state type of activity to be authorised, if not already stated, and give relevant further details, for example (but not exclusively) whether or not music will be amplified or unamplified.

6. For example (but not exclusively), where the activity will occur on additional days during the summer months.
7. For example (but not exclusively), where you wish the activity to go on longer on a particular day e.g. Christmas Eve.
8. Please give timings in 24 hour clock (e.g. 16.00) and only give details for the days of the week when you intend the premises to be used for the activity.
9. If you wish people to be able to consume alcohol on the premises, please tick 'on the premises'. If you wish people to be able to purchase alcohol to consume away from the premises, please tick 'off the premises'. If you wish people to be able to do both, please tick 'both'.
10. Please give information about anything intended to occur at the premises or ancillary to the use of the premises which may give rise to concern in respect of children regardless of whether you intend children to have access to the premises, for example (but not exclusively) nudity or semi-nudity, films for restricted age groups or the presence of gaming machines.
11. Please list here steps you will take to promote all four licensing objectives together.
12. The application form must be signed.
13. An applicant's agent (for example solicitor) may sign the form on their behalf provided that they have actual authority to do so.
14. Where there is more than one applicant, each of the applicants or their respective agents must sign the application form.
15. This is the address which we shall use to correspond with you about this application.

From: [REDACTED] >

Sent: 19 September 2023 10:36

To: licensing inbox [REDACTED]

Subject: Papa Johns Pizza Camden High Street PREM-LIC/1545

Good morning guys

As you can see from the below email – an agreement with police has been reached regarding the above application to vary their hours.

Can you please update their licence application accordingly and amend their hours to

- Until 2am for collections 7 days a week and,
- Until 3am for deliveries 7 days a week

Once this has been done and I have a confirmation of this I will be able to confirm that the MPS will not be putting in any representations regarding this application.

Many thanks and Kind Regards

Kevin



Police Constable Nicholls [REDACTED]
Camden Licensing Unit
Kentish Town Police Station
12A Holmes Road
London NW53AE

-- Official

From: Walaiti Rathore [REDACTED]

Sent: 18 September 2023 17:27

To: Nicholls Kevin - CN-CU [REDACTED]

Subject: RE: Papa Johns Pizza Camden High Street PREM-LIC/1545

Hi Kevin,

Further to the emails below, I can confirm that the suggested amendments to the terminal hours for late night refreshment are agreed as follows:

- Until 2am for collections 7 days a week and,
- Until 3am for deliveries 7 days a week

I trust this is satisfactory.

Many thanks.

Kind regards

Walaiti

Walaiti Rathore
Managing Director

Licensing Law Consultancy

[Redacted]

[Redacted]

[Redacted]

[Redacted] Law Consultancy is the trading name of Licence Law Consultancy Limited.
Registered in England and Wales.
Registered number: 10580885
Registered office: 18 The Ropewalk,
Nottingham, NG1 5DT

Confidentiality: This e-mail and its attachments are intended for the above named only and may be confidential. If they have come to you in error you must take no action based on them, nor must you copy or show them to anyone; please reply to this e-mail and highlight the error.

Security Warning: Please note that this e-mail has been created in the knowledge that Internet e-mail is not 100% secure communications medium. We advise that you understand and observe this lack of security when e-mailing us.

Viruses: Although we have taken steps to ensure that this e-mail and attachments are free from any virus, we advise that in keeping with good computing practice the recipient should ensure that they are actually virus free.

From: [Redacted]
Sent: Monday, September 18, 2023 1:58 PM
To: Walaiti Rathore [Redacted]
Subject: RE: Papa Johns Pizza Camden High Street PREM-LIC/1545

Hi Walaiti

That would be appreciated – Thank you 😊

Kind Regards

Kevin



Police Constable Nicholls [Redacted]
Camden Licensing Unit
Kentish Town Police Station
12A Holmes Road
London NW53AE

[Redacted]
[Redacted] **-- Official**

From: Walaiti Rathore [Redacted]
Sent: 18 September 2023 13:55
To: Nicholls Kevin - CN-CU [Redacted]
Subject: Re: Papa Johns Pizza Camden High Street PREM-LIC/1545

Hi Kevin,

I think it should all be fine but I will confirm in writing by this evening.

Many thanks.

Kind regards

Walaiti

Sent from [Outlook for iOS](#)

From: [Kevin](#) [Redacted]
Sent: Monday, September 18, 2023 1:45:33 PM
To: Walaiti Rathore [Redacted]
Subject: RE: Papa Johns Pizza Camden High Street PREM-LIC/1545

Hi Walaiti

Have you had a chance to speak with your client regarding the proposed hours etc -

Kind Regards

Kevin



Police Constable Nicholls [Redacted]
Camden Licensing Unit
Kentish Town Police Station
12A Holmes Road
London NW53AE

[Redacted]
[Redacted] **-- Official**

From: Walaiti Rathore [Redacted]
Sent: 12 September 2023 13:48
To: Nicholls Kevin - CN-CU [Redacted]
Subject: RE: Papa Johns Pizza Camden High Street PREM-LIC/1545

Hi Kevin,

Thank you for call today and your email.

As discussed, I will have an opportunity to speak to my client at the end of the week and I will then come back to you early next week.

Thank you for your help with this matter.

Kind regards

Walaiti

Walaiti Rathore
Managing Director

Licensing Law Consultancy

[Redacted]

[Redacted]

[Redacted]

Licensing Law Consultancy is the trading name of Licence Law Consultancy Limited.
Registered in England and Wales.
Registered number: 10580885
Registered office: 18 The Ropewalk,
Nottingham, NG1 5DT

Confidentiality: This e-mail and its attachments are intended for the above named only and may be confidential. If they have come to you in error you must take no action based on them, nor must you copy or show them to anyone; please reply to this e-mail and highlight the error.

Security Warning: Please note that this e-mail has been created in the knowledge that Internet e-mail is not 100% secure communications medium. We advise that you understand and observe this lack of security when e-mailing us.

Viruses: Although we have taken steps to ensure that this e-mail and attachments are free from any virus, we advise that in keeping with good computing practice the recipient should ensure that they are actually virus free.

From [Redacted] >
Sent: Tuesday, September 12, 2023 1:46 PM
To: Walaiti Rathore <[Redacted]>
Subject: Papa Johns Pizza Camden High Street PREM-LIC/1545

Dear Walaiti

As discussed on the telephone just now – we spoke about the possibility of 3am across-the-board finishes with a last collection at 2am.

Once you have spoken to your client, feel free to email on my personal email

[Redacted]

Kind Regards

Kevin



Police Constable Nicholls [REDACTED]
Camden Licensing Unit
Kentish Town Police Station
12A Holmes Road
London NW53AE

[REDACTED]



London Borough of Camden, Town Hall,
Judd Street, London, WC1H 9JE

Premises Licence
London Borough of Camden Licensing Authority

Premises licence number PREM-LIC1545

Part 1 – Premises details

Postal address of premises, or if none, ordnance survey map reference or description

Papa Johns
51A CAMDEN HIGH STREET
LONDON
NW1 7JH

Telephone number

Where the licence is time limited the dates

N/A

Licensable activities authorised by the licence

Late Night Refreshment

The times the licence authorises the carrying out of licensable activities

Late Night Refreshment:

Monday to Thursday: 23:00 to 01:00

Friday to Saturday: 23:00 to 02:00

Sunday: 23:00 to 00:00

The opening hours of the premises

Not Known

Where the licence authorises supplies of alcohol whether these are on and/or off supplies

N/A

**Part 2**

Name, (registered) address, telephone number and e-mail (where relevant) of holder of premises licence

DFSI M25 Ltd
Unit 1 Westward Parade
Pepper Street
London
E14 9DZ

Registered number of holder, for example company number, charity number (where applicable)

13240874

Name, address and telephone number of designated premises supervisor where the premises licence authorises the supply of alcohol

N/A

Personal licence number and issuing authority of personal licence held by designated premises supervisor where the premises licence authorises the supply of alcohol

N/A

Signed on behalf of the Director, Culture and Environment Department



Date Licence Amended: 01/06/2022 - APP\PREMISES-TRANS\110243

Date Licence Amended: 04/06/2020 - APP\PREMISES-TRANS\101853

Date Licence Amended: 23/11/2012 - APP\PREMISES-VARY\000742

Date Licence Amended: 09/08/2012 - APP\PREMISES-TRANS\000946

Date: 17/12/2005



Annex 1 - Mandatory conditions

N/A

Annex 2 - Conditions consistent with the Operating Schedule

1. All staff shall be fully trained in the four licensing objectives.
2. There shall be a regular litter patrol around the premises to keep the street clear of any litter associated with the business.
3. CCTV shall be installed and will monitor activity to ensure public safety.
4. CCTV records shall be maintained and Police shall have immediate use and access to the system.
5. Signs shall be displayed requesting that customers and staff leave quietly to avoid disturbance to our neighbours.
6. The manager on duty shall be trained to deal with any issues arising from children in the premises.

Annex 3 - Conditions attached after a hearing by the licensing authority 22/11/2012

7. No scooters to be permitted in Miller Street after 22:00

Annex 4 - Plans



London Borough of Camden, Town Hall,
Judd Street, London, WC1H 9JE

Premises licence summary

Premises licence number	PREM-LIC\1545
--------------------------------	---------------

Premises details

Postal address of premises, or if none, ordnance survey map reference or description

Papa Johns
51A CAMDEN HIGH STREET
LONDON
NW1 7JH

Telephone number

Where the licence is time limited the dates

N/A

Licensable Activities authorised by the licence

Late Night Refreshment

The times the licence authorises the carrying out of licensable activities

Late Night Refreshment:

Monday to Thursday: 23:00 to 01:00

Friday to Saturday: 23:00 to 02:00

Sunday: 23:00 to 00:00

The opening hours of the premises

Not Known

Where the licence authorises supplies of alcohol whether these are on and/or off supplies

N/A

**Name, (registered) address of holder of premises licence**

DFSI M25 Ltd
Unit 1 Westward Parade
Pepper Street
London
E14 9DZ

Registered number of holder, for example company number, charity number (where applicable)

13240874

Name of designated premises supervisor where the premises licence authorises the supply of alcohol

N/A

State whether access to the premises by children is restricted or prohibited

N/A

CAMDEN HIGH STREET

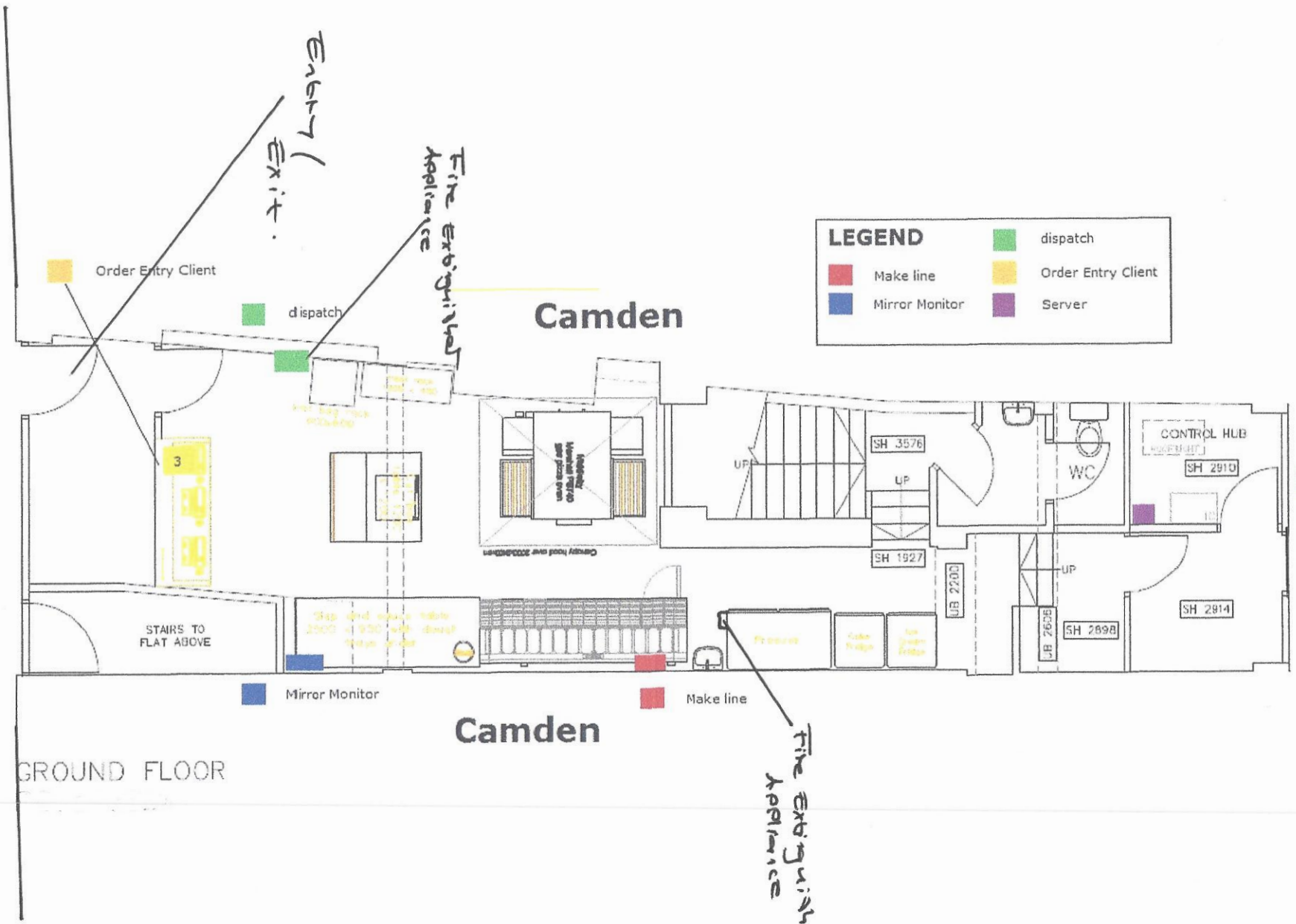

LEGEND

■	Make line	■	dispatch
■	Mirror Monitor	■	Order Entry Client
		■	Server

PLAN of

51a CAMDEN HIGH STREET
LONDON NW1 7JH

1:100

GROUND FLOOR

Date: 06/09/2023
Application Reference: APP\PREMSES-VARY\116595
Direct Phone Number:
Contact: Esther Jones
E-mail: [REDACTED]



Public Protection
 Supporting Communities
 London Borough of Camden
 5 Pancras Square
 LONDON
 N1C 1AG

Please quote our reference in any correspondence

Licensing (Contact Camden)
 Crowndale Centre
 218 Eversholt Street
 London
 NW1 1BD

Tel: 020 7974 4444 (switchboard)

London Borough of Camden
 Fax: 020 7974 6955 / 6940
 Textphone: 020 7974 6866

DX: 2106 Euston

www.camden.gov.uk

Licensing Act 2003

**Re: PAPA JOHNS 51A CAMDEN HIGH STREET, LONDON NW1 7JH PREM LIC
 \1545**

LICENSING AUTHORITY REPRESENTATION

This representation is made by the Licensing Authority, and it relates to the following licensing objectives: -

- Prevention of public nuisance

The Premises and Summary of Application

The application is to vary a premises licence for the above premises by extending the hours for licensable activities and to include a condition to the premises licence.

This premises does not wish to supply alcohol but only wish to provide delivery only service after 02:00 every day which would technically make it a 24-hour premises since a licence is not needed before 23pm and after 05:00am.

The premises is asking for the following: -

Provision of late-night refreshment

Monday to Sunday 23:00 – 05:00

Operational Hours of the premises

Monday to Sunday 00:00 – 24:00 (24 hours, 7 days a week)

Framework Hours – Pages 36 of The Licensing Policy

The operating hours are outside the framework hours which are: -

On- Licence:

- Monday to Thursday 1000 hours until 2330 hours
- Friday and Saturday 1000 hours until midnight

- Sunday 1100 hours until 2230 hours

Off- Licence:

- Monday to Saturday 0800 hours until 2300 hours
- Sunday 1000 hours until 2230 hours

Cumulative Impact Areas

The premises is situated in the Camden Town Cumulative Impact Area, where there is a presumption to refuse all new and variation applications in its entirety, as set out in Chapter 6 of the Licensing Policy (Cumulative Impact Policies). While this presumption is rebuttable, this is only in exceptional circumstances where the applicant has successfully demonstrated that the granting of their application would not contribute or exacerbate the existing impact of licensed premises in that area.

Complaints

A check of the council's record in the past 2 years shows that there's been no complaints regarding the premises.

Conclusion

Whilst aware of the fact that this premises would be in the main a 24-hour premises, and there is the likelihood that it may attract revellers leaving other premises, it is mainly food led and the applicant has provided a condition that "The premises shall close to the public after 02:00 and will then operate solely as a delivery service until 05:00". That makes it very similar to the same type of premises of the same name currently operating at Farringdon.

This reduces the risk of it being a gathering point for other late-night visitors.

However, the premises has not identified how they intend to ensure that waste from their operations would not be a source of nuisance to residents or how they intend to manage delivery vehicles and staff in the early hours of the morning such that they do not create a noise disturbance and engage with the licensing objective the prevention of public nuisance.

To this extent, I would also ask that should the panel be minded to grant the variation to the premises licence, the following conditions be imposed.

- The premises to sign up for the "Ask for Angela" scheme and that this should be done before they begin operations.
- That suitable and sufficient refuse receptacles be provided to such that all waste and refuse produced by the business in the course of its operation, is collected, properly stored and disposed off.

Yours sincerely



Esther Jones
Licensing Team Leader

Representation	
Premises name	Papa Johns
Application reference number	APP\PREMISES-VARY\116595
Last date for representation	21/09/2023

Making a representation as

As an organisation

Your details**Organisation name**

TRACT

First name

Kathryn Anne

Last name

Gemmell

Telephone number (optional)**Email address****Address**3 Ivor Street
London
NW1 9PL**Remain anonymous**

No

Grounds of representation

- prevention of public nuisance

Details of representation

The premises is in the cumulative impact area and whilst on the High Street, there are significant residential homes above the retail. The intention appears to be to operate 24/7 delivery service which will cause noise nuisance from motorised vehicles, operatives on phones and potentially the restaurant extract. The deliveries are likely to take vehicles into residential streets and cause noise disturbance. If approved this licence

variation will add to the cumulative impact in the area. The applicant has not even offered any mitigating measures.

About this form

Issued by

Camden Town Hall
Judd Street
London
WC1H 9JE

Contact phone

020 7974 4444

Data protection

No personal information you have given us will be passed on to third parties for commercial purposes. The Council's policy is that all information will be shared among officers and other agencies where the legal framework allows it, if this will help to improve the service you receive and to develop other services. If you do not wish certain information about you to be exchanged within the Council, you can request that this does not happen.

From: Kate McLaren [REDACTED]
Sent: 27 September 2023 15:21
To: Sarah Williams [REDACTED]
Cc: Walaiti Rathore [REDACTED]
[REDACTED]

Subject: RE: 116595: Papa Johns Pizza Camden High Street PREM-LIC/1545

Hi Sarah,
Having reviewed the in force licence and the proposals we remain not satisfied.

Extending the hours of operation and deliveries will most certainly add to the cumulative impact in the area.

Some conditions have been dropped from the in force licence and I'm afraid public nuisance is not mitigated in the current proposal.

Best Kate

Sent from [Mail](#) for Windows

From: [Sarah Williams](#)
Sent: 27 September 2023 13:05
To: [Kate McLaren](#)
Cc: [Walaiti Rathore \(walaiti.rathore@licensinglawconsultancy.co.uk\)](mailto:walaiti.rathore@licensinglawconsultancy.co.uk); [Esther Jones](#)
Subject: 116595: Papa Johns Pizza Camden High Street PREM-LIC/1545

Dear Kate,

Thank you for your attached representation for Papa Johns Pizza Camden High Street.

I can confirm that there has been some mediation and amendments to this application from both the Police and Licensing Responsible Authority

The application is now to vary their hours;

- Until 2am for collections 7 days a week and,
- Until 3am for deliveries 7 days a week

This is to include two additional conditions;

- The premises to sign up for the "Ask for Angela" scheme and that this should be done before they begin operations.
- That suitable and sufficient refuse receptacles be provided to such that all waste and refuse produced by the business in the course of its operation, is collected, properly stored and disposed of.

Please confirm if this now satisfies your concerns and if you would like to withdraw your representation?

Kind Regards

Sarah Williams
Licensing Officer
Supporting Communities
London Borough of Camden

Web: camden.gov.uk

5 Pancras Square
London N1C 4AG

Conditions consistent with the operating schedule

The existing conditions will remain on the premises licence.

1. The premises shall close to the public after 02:00 and will then operate solely as a delivery service until 03:00.
2. The premises will operate in accordance with all relevant legislation.
3. Arrangements for the storage and disposal of refuse will not cause a nuisance.

Conditions agreed with the Police Responsible Authority

1. The premises shall close to the public after 02:00 and will then operate solely as a delivery service until 03:00.

Conditions agreed with the Licensing Responsible Authority

2. The premises to sign up for the "Ask for Angela" scheme and that this should be done before they begin operations.
3. That suitable and sufficient refuse receptacles be provided such that all waste and refuse produced by the business in the course of its operation, is collected, properly stored and disposed of.

Section 1: Background comments of the Borough Solicitor

- 1.1 The purpose of Camden's Statement of Licensing Policy is to make it clear to applicants that wider considerations will be taken into account when determining applications. It is intended to guide the Licensing Panel when considering licence applications. However, the Licensing Panel must always consider each application on its own merits and allow exceptions to the normal policy where the circumstances of the application justify allowing an exception. The burden is on the applicant to show that they comply with the policy.
- 1.2 Members should only address those matters that have formed the subject matter of relevant representations. Matters that arise that are not the subject of relevant representations fall outside the function that the Panel is exercising when it holds a hearing
- 1.3 Members must determine, having regard for the evidence, whether granting the application for a premises licence will impact adversely on the policy criteria listed in paragraph 3 of this report.
- 1.4 In accordance with the provisions of Part 1 of Schedule 5 of the Act, where a Licensing Authority rejects in whole or in part, an application for a new premises licence, the applicant may appeal against the decision, to a magistrate's court within 21 days of being notified of the decision.
- 1.5 Similarly, where a person who made relevant representations in relation to the application contends that the licence ought not to have been granted, or that different or additional conditions should have been imposed on the licence, he may appeal against the decision to a magistrate's court within 21 days of being notified of the decision.
- 1.6 **The Human Rights Act 1998** incorporates the key articles of the European Convention on Human Rights into domestic law. Decisions on licensing matters are actions of a public authority and must be compatible with Convention rights. Consequently, Members of the Panel must be aware of the rights contained in the Convention (particularly those set out below) when making licensing decisions.

(a) Article 6: Right to a fair trial

In the determination of his civil rights and obligations, everyone is entitled to a fair and public hearing within a reasonable time by an independent and impartial tribunal established by law.

(b) Article 8: Right to respect for private and family life

Everyone has a right to respect for his or her private life, his home and correspondence.

(c) Article 1 of the First Protocol: Protection of property

Every natural or legal person is entitled to the peaceful enjoyment of his possessions, including a licence. No one shall be deprived of his possession except in the public interest and subject to the conditions provided for by law and by the general principles of international law.

(d) Article 10: Freedom of Expression

Everyone has the right to freedom of expression. This right shall include freedom to hold opinions and to receive and impart information and ideas without interference by public authority and regardless of frontiers. This Article shall not prevent States from requiring the licensing of broadcasting, television or cinema enterprises.

The exercise of these freedoms since it carries with it duties and responsibilities may be subject to such formalities, conditions, restrictions or penalties as are prescribed by law and are necessary in a democratic society, in the interests of national security, territorial integrity or public safety, for the prevention of disorder or crime, for the protection of health and morals, for the protection of the reputation or rights of others, for preventing the disclosure of information received in confidence, or for maintaining the authority and impartiality of the judiciary.

(e) Article 14: Prohibition of discrimination

The enjoyment of the rights and freedoms set forth in this Convention shall be secured without discrimination on any ground such as sex, race, colour, language, religion, political or other opinion, national or social origin, association with a national minority, property, birth, or other status.

- 1.7 When formulating policy local authorities must have regard to the **Equality Act 2010**. The Act provides protection from discrimination in respect of certain protected characteristics, namely: age, disability, gender reassignment, pregnancy and maternity, race, religion or beliefs and sex and sexual orientation. It places the Council under a legal duty to have due regard to the advancement of equality in the exercise of its powers including licensing powers. Members of the panel must be mindful of this duty when determining all licensing applications.

The section 149 Public Sector Equality Duty

- (1) A public authority must, in the exercise of its functions, have due regard to the need to—
- (a) eliminate discrimination, harassment, victimisation and any other conduct that is prohibited by or under this Act;
 - (b) advance equality of opportunity between persons who share a relevant protected characteristic and persons who do not share it;
 - (c) foster good relations between persons who share a relevant protected characteristic and persons who do not share it.

(2) A person who is not a public authority but who exercises public functions must, in the exercise of those functions, have due regard to the matters mentioned in subsection (1).

(3) Having due regard to the need to advance equality of opportunity between persons who share a relevant protected characteristic and persons who do not share it involves having due regard, in particular, to the need to—

(a) remove or minimise disadvantages suffered by persons who share a relevant protected characteristic that are connected to that characteristic;

(b) take steps to meet the needs of persons who share a relevant protected characteristic that are different from the needs of persons who do not share it;

(c) encourage persons who share a relevant protected characteristic to participate in public life or in any other activity in which participation by such persons is disproportionately low.

(4) The steps involved in meeting the needs of disabled persons that are different from the needs of persons who are not disabled include, in particular, steps to take account of disabled persons' disabilities.

(5) Having due regard to the need to foster good relations between persons who share a relevant protected characteristic and persons who do not share it involves having due regard, in particular, to the need to—

- (a) tackle prejudice, and
- (b) promote understanding.

(6) Compliance with the duties in this section may involve treating some persons more favourably than others; but that is not to be taken as permitting conduct that would otherwise be prohibited by or under this Act.

1.8 In determining any application, the Council must comply with the public sector equality duty in s.149 of the 2010 Act. This is a duty to have regard to the need to achieve the statutory goals of s.149, rather than to achieve a particular result. The s149 duty sits alongside and does not override statutory requirements in relation to determining licensing applications, including the duty to consider all evidence on its merits and the legislative criteria listed at paragraphs 3 & 4.

1.9 When members have before them representations or other material on issues relevant to s149, even outside the scope of “standard” licensing considerations such material must still be specifically assessed in the context of s149. However, because s149 creates a requirement to “have regard” the fact a matter raised is relevant to s149 will not automatically translate into a reason for refusing an application that would be sustainable in any subsequent appeal, given the legal requirement to determine applications in compliance with licensing legislation.

Section 2: Financial Comments

- 2.1 Following consideration there are no financial implications concerning this application. The Executive Director Corporate Services has been consulted in the preparation of this report and has no further comments to add.