



London Borough of Camden, 5 Pancras Square, London N1C 4AG

Premises Licence

London Borough of Camden Licensing Authority

Premises licence number

PREM-LIC\113657

Part 1 – Premises details

Postal address of premises, or if none, ordnance survey map reference or description

KISS THE SKY
11-13 Camden High Street
London
NW1 7JE

Telephone number N/A

Where the licence is time limited the dates

N/A

Licensable activities authorised by the licence

Retail of Alcohol:	Yes
Recorded Music:	Yes
Live Music:	Yes

The times the licence authorises the carrying out of licensable activities

Retail of Alcohol:	
Monday to Saturday:	09:00 – 01:00
Sunday:	10:00 – 23:30
Recorded Music:	
Monday to Saturday:	23:00 – 01:30
Sunday:	23:00 – 23:30
Live Music:	
Monday to Saturday:	23:00 – 01:30
Sunday:	23:00 – 23:30



The opening hours of the premises

Monday to Saturday: 07:00 – 01:45

Sunday: 10:00 – 01:00

Where the licence authorises supplies of alcohol whether these are on and/or off supplies:

ON Premises

Part 2

Name, (registered) address, telephone number and e-mail (where relevant) of holder of premises licence

St Georges Hotel Inn Limited
10 SUSSEX GARDENS
LONDON
W2 1UL

Registered number of holder, for example company number, charity number (where applicable)

05313775

Name, address and telephone number of designated premises supervisor where the premises licence authorises the supply of alcohol

[REDACTED]

Personal licence number and issuing authority of personal licence held by designated premises supervisor where the premises licence authorises the supply of alcohol

[REDACTED]

For Corporate Services Directorate on behalf of the Licensing Authority

[REDACTED]

Date Licence Granted: 20/04/2023 APP\PREMISES-NEW\113658



Annex 1 - Mandatory conditions

1. The supply of alcohol is prohibited at a time when there is no designated premises supervisor in respect of the premises.
2. The supply of alcohol is prohibited at a time when the designated premises supervisor does not hold a personal licence or his/her licence is suspended.
3. Every supply of alcohol under the premises licence must be made or authorised by a person who holds a personal licence.
4. Where a premises licence includes a condition that at specified times one or more individuals must be at the premises to carry out a security activity, the licence must include a condition that each such individual must
 - (a) be authorised to carry out that activity by a licence granted under the Private Security Industry Act 2001; or
 - (b) be entitled to carry out that activity by virtue of section 4 of that Act.
5. But nothing in subsection (4) requires such a condition to be imposed -
 - (a) in respect of premises within paragraph 8(3)(a) of Schedule 2 to the Private Security Industry Act 2001 (c. 12) (premises with premises licences authorising plays or films), or
 - (b) in respect of premises in relation to -
 - (i) any occasion mentioned in paragraph 8(3)(b) or (c) of that Schedule (premises being used exclusively by club with club premises certificate, under a temporary event notice authorising plays or films or under a gaming licence), or
 - (ii) any occasion within paragraph 8(3)(d) of that Schedule (occasions prescribed by regulations under that Act).
6. For the purposes of this section
 - (a) "security activity" means an activity to which paragraph 2(1)(a) of that Schedule applies[and which is licensable conduct for the purposes of that Act (see section 3(2) of that Act)], and
 - (b) paragraph 8(5) of that Schedule (interpretation of references to an occasion) applies as it applies in relation to paragraph 8 of that Schedule.
7.
 - (1) The responsible person must ensure that staff on relevant premises do not carry out, arrange or participate in any irresponsible promotions in relation to the premises.
 - (2) In this paragraph, an irresponsible promotion means any one or more of



the following activities, or substantially similar activities, carried on for the purpose of encouraging the sale or supply of alcohol for consumption on the premises

- (a) games or other activities which require or encourage, or are designed to require or encourage, individuals to
 - (i) drink a quantity of alcohol within a time limit (other than to drink alcohol sold or supplied on the premises before the cessation of the period in which the responsible person is authorised to sell or supply alcohol), or
 - (ii) drink as much alcohol as possible (whether within a time limit or otherwise);
 - (b) provision of unlimited or unspecified quantities of alcohol free or for a fixed or discounted fee to the public or to a group defined by a particular characteristic in a manner which carries a significant risk of undermining a licensing objective;
 - (c) provision of free or discounted alcohol or any other thing as a prize to encourage or reward the purchase and consumption of alcohol over a period of 24 hours or less in a manner which carries a significant risk of undermining a licensing objective;
 - (d) selling or supplying alcohol in association with promotional posters or flyers on, or in the vicinity of, the premises which can reasonably be considered to condone, encourage or glamorise anti-social behaviour or to refer to the effects of drunkenness in any favourable manner;
 - (e) dispensing alcohol directly by one person into the mouth of another (other than where that other person is unable to drink without assistance by reason of disability).
8. The responsible person must ensure that free potable water is provided on request to customers where it is reasonably available.
9. (1) The premises licence holder or club premises certificate holder must ensure that an age verification policy is adopted in respect of the premises in relation to the sale or supply of alcohol.
- (2) The designated premises supervisor in relation to the premises licence must ensure that the supply of alcohol at the premises is carried on in accordance with the age verification policy.
- (3) The policy must require individuals who appear to the responsible person to be under 18 years of age (or such older age as may be specified in the policy) to produce on request, before being served alcohol, identification bearing their photograph, date of birth and either
- (a) a holographic mark, or
 - (b) an ultraviolet feature.



10. The responsible person must ensure that
- (a) where any of the following alcoholic drinks is sold or supplied for consumption on the premises (other than alcoholic drinks sold or supplied having been made up in advance ready for sale or supply in a securely closed container) it is available to customers in the following measures
 - (i) beer or cider: ½ pint;
 - (ii) gin, rum, vodka or whisky: 25 ml or 35 ml; and
 - (iii) still wine in a glass: 125 ml;
 - (b) these measures are displayed in a menu, price list or other printed material which is available to customers on the premises; and
 - (c) where a customer does not in relation to a sale of alcohol specify the quantity of alcohol to be sold, the customer is made aware that these measures are available.
11. A relevant person shall ensure that no alcohol is sold or supplied for consumption on or off the premises for a price which is less than the permitted price.
12. For the purposes of the condition set out in paragraph 11
- (a) “duty” is to be construed in accordance with the Alcoholic Liquor Duties Act 1979
 - (b) “permitted price” is the price found by applying the formula

$$P = D + (D \times V)$$
 where
 - (i) P is the permitted price,
 - (ii) D is the rate of duty chargeable in relation to the alcohol as if the duty were charged on the date of the sale or supply of the alcohol, and
 - (iii) V is the rate of value added tax chargeable in relation to the alcohol as if the value added tax were charged on the date of the sale or supply of the alcohol;
 - (c) “relevant person” means, in relation to premises in respect of which there is in force a premises licence
 - (i) the holder of the premises licence,
 - (ii) the designated premises supervisor (if any) in respect of such a licence, or
 - (iii) the personal licence holder who makes or authorises a supply of alcohol under such a licence;
 - (d) “relevant person” means, in relation to premises in respect of which there is in force a club premises certificate, any member or officer of the club present on the premises in a capacity which enables the member or officer to prevent the supply in question; and



(e) "valued added tax" means value added tax charged in accordance with the Value Added Tax Act 1994.

13. Where the permitted price given by Paragraph (b) of 12 above would (apart from this paragraph) not be a whole number of pennies, the price given by that sub-paragraph shall be taken to be the price actually given by that sub-paragraph rounded up to the nearest penny.
14. (1) Sub-paragraph (2) applies where the permitted price given by Paragraph (b) of paragraph 2 on a day ("the first day") would be different from the permitted price on the next day ("the second day") as a result of a change to the rate of duty or value added tax.
 (2) The permitted price which would apply on the first day applies to sales or supplies of alcohol which take place before the expiry of the period of 14 days beginning on the second day.

Annex 2 - Conditions consistent with the operating schedule

N/A

Annex 3 - Conditions attached after a hearing by the licensing authority

15. There shall be a personal licence holder on duty on the premises at all times when the premises are authorised to sell alcohol.
16. The premises shall install and maintain a comprehensive CCTV system as per the minimum requirements of the Camden Police Licensing Team and that:
 - a) All entry and exit points will be covered enabling frontal identification of every person entering in any light condition;
 - b) The CCTV system shall continually record whilst the premises is open for licensable activities and during all times when customers remain on the premises and will include the external area immediately outside the premises entrance;
 - c) All recordings shall be stored for a minimum period of 31 days with date and time stamping;
 - d) Viewing of recordings shall be made available within 48 hours, where possible, upon the request of Police or authorised officer throughout the entire 31-day period; and
 - e) Signs must be displayed in the customer areas to advise that CCTV is in operation.
17. A staff member from the premises who is conversant with the operation of the CCTV system shall be on the premises at all times when the premises is open. This staff member must be able to provide a Police or authorised council officer copies of recent CCTV images or data with the absolute minimum of delay when requested.



18. The Premises Licence Holder shall employ a minimum of 1 x SIA Licensed Door Supervisors at the Premises on a Friday and Saturday night from 21:00hrs until 02:00hrs.
19. The Premises Licence Holder shall risk assess the need for SIA Licensed Door Supervisors at other times I additional SIA Licensed Door Supervisors on a Friday and Saturday night.
20. An incident log shall be kept at the premises and made available on request to an authorised Officer of the Council or the Police. It must be completed within 24 hours of the incident and will record the following:
 - a) all crimes reported to the venue
 - b) all ejections of patrons
 - c) any complaints received concerning crime and disorder
 - d) any incidents of disorder
 - e) all seizures of drugs or offensive weapons
 - f) any faults in the CCTV system, searching equipment or scanning equipment
 - g) any refusal of the sale of alcohol
 - h) any visit by a relevant authority or emergency service.
21. In the event that a serious assault is committed on the premises (or appears to have been committed) the management will immediately ensure that:
 - a) The police (and, where appropriate, the London Ambulance Service) are called without delay;
 - b) All measures that are reasonably practicable are taken to apprehend any suspects pending the arrival of the police;
 - c) The crime scene is preserved so as to enable a full forensic investigation to be carried out by the police; and
 - d) Such other measures are taken (as appropriate) to fully protect the safety of all persons present on the premises.
22. As soon as possible, and in any event within I month from the grant of this licence, the premises shall join the local Pubwatch or other local crime reduction scheme approved by the police, and local radio scheme if available.
23. The venue shall supply, and fit, suitable anti-theft devices such as table/counter clips, in order that customers must secure their bags.
24. A copy of the premises' dispersal policy shall be made readily available at the premises for inspection by a police officer and/or an authorised officer of the Council.
25. A comprehensive staff training programme is to be put together which will cover the Licensing Act 2003, fire evacuation procedures, critical incident best-practice, crime scene best practice and WAVE training. This training is to be clearly documented.



26. Patrons permitted to temporarily leave and then re-enter the premises, e.g. to smoke or make a phone call, shall not be permitted to take glass containers with them.
27. A noise limiter must be fitted to the musical amplification system and maintained in accordance with the following criteria:
 - a) the limiter must be set at a level determined by and to the satisfaction of an Acoustician who is a member of the Institute of Acoustics so as to ensure that no noise nuisance is caused to local residents or businesses;
 - b) The operational panel of the noise limiter shall then be secured by key or password to the satisfaction of an Acoustician who is a member of the Institute of Acoustics and access shall only be by persons authorised by the Premises Licence holder;
 - c) The limiter shall not be altered without prior written agreement from Licensing Authority;
 - d) No alteration or modification to any existing sound system(s) should be affected without prior knowledge of the Licensing Authority, and
 - e) No additional sound generating equipment shall be used on the premises without being routed through the sound limiter device.
28. All windows and external doors shall be kept closed after 21:00 hours, or at any time when Regulated Entertainment takes place, except for the immediate access and egress of persons.
29. Notices shall be prominently displayed at all exits requesting patrons to respect the needs of local residents and businesses and leave the area quietly.
30. Notices shall be prominently displayed at any area used for smoking requesting patrons to respect the needs of local residents and use the area quietly.
31. Patrons permitted to temporarily leave and then re-enter the premises, e.g. to smoke or make a phone call, shall be limited to 10 persons at any one time.
32. A Challenge 25 proof of age scheme shall be operated at the premises where the only acceptable forms of identification are recognised photographic identification cards, such as a driving licence, passport or proof of age card with the PASS Hologram.
33. Last entry to the premises shall be 00:00hrs.
34. The premises shall sign up to the 'Ask for Angela' scheme.
35. The capacity of the venue shall be 50 patrons.

Annex 4 - Plans



London Borough of Camden, 5 Pancras Square, London N1C 4AG

Premises Licence Summary
London Borough of Camden Licensing Authority

Premises licence number PREM-LIC\113657

Part 1 – Premises details

Postal address of premises, or if none, ordnance survey map reference or description KISS THE SKY 11-13 Camden High Street London NW1 7JE
Telephone number N/A

Where the licence is time limited the dates N/A

Licensable activities authorised by the licence	
Retail of Alcohol:	Yes
Recorded Music:	Yes
Live Music:	Yes

The times the licence authorises the carrying out of licensable activities	
Retail of Alcohol:	
Monday to Saturday:	09:00 – 01:00
Sunday:	10:00 – 23:30
Recorded Music:	
Monday to Saturday:	23:00 – 01:30
Sunday:	23:00 – 23:30
Live Music:	
Monday to Saturday:	23:00 – 01:30
Sunday:	23:00 – 23:30

**The opening hours of the premises**

Monday to Saturday: 07:00 – 01:45

Sunday: 10:00 – 01:00

Where the licence authorises supplies of alcohol whether these are on and/or off supplies

ON Premises

Part 2**Name, (registered) address of holder of premises licence**

St Georges Hotel Inn Limited
10 SUSSEX GARDENS
LONDON
W2 1UL

Registered number of holder, for example company number, charity number (where applicable)

05313775

Name of designated premises supervisor where the premises licence authorises the supply of alcohol

[REDACTED]

State whether access to the premises by children is restricted or prohibited

N/A

KISS THE SKY - LICENSING PLAN

1. licensable activities may take place anywhere within the red line
2. any detail not required by the regulations is indicative only and subject to change without notice
3. fire safety locations indicative + may change in consultation with LFB and/or following a fire risk assessment

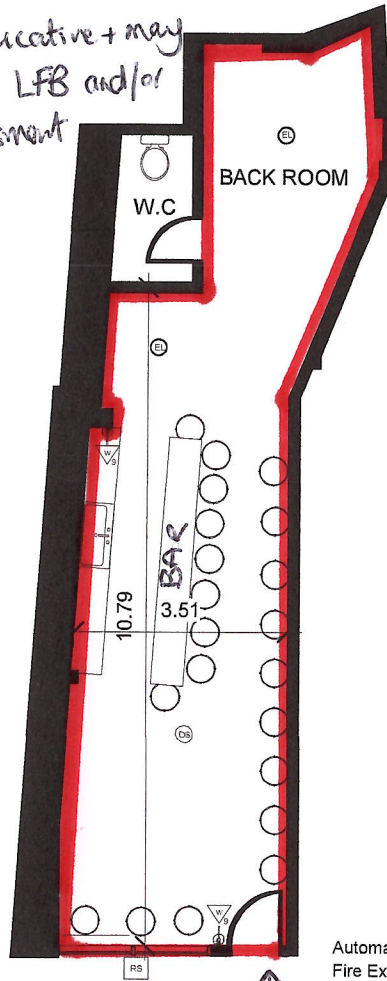

= extent of licensed premises

Automatic fire alarm = DS
 Fire Extinguisher = (circle with cross)
 Fire resisting door (curved line)
 30/30 door (curved line with '30/30')
 EL = (circle with dot)
 Seat = (circle)

1 FLOOR PLAN 1 : 100 entrance / exit

AUTODESK. www.autodesk.com/revit	Owner	Unnamed	
	Project Name	Project number	0001
Date		Issue Date	A101
Drawn by		Author	
Checked by	Checker	Scale	1 : 100