

- GENERAL NOTES -**
1. Licenseable activities must take place anywhere within the red line.
  2. Any Detail not required by the regulations is indicative only and may change without notice.
  3. The locations of fire safety equipment are indicative only and may change on advice from the fire service or following a fire risk assessment.

RED LINE INDICATES EXTENT OF LICENSED PREMISES

- SOUNDER
- CCTV CAMERA

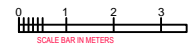

- KEY**
- EMERGENCY LIGHT COMBINED FITTING- ALL NEW
  - FLASHING BEACON
  - AREA TO BE COVERED BY A SMOKE / HEAT DETECTOR (LOCATION TO BE CONFIRMED BY ALARM CONSULTANT)
  - CALL POINT
  - ALARM PANEL
  - 30 MINUTE INTEGRITY/30 MINUTE INSULATION FIRE DOOR WITH SMOKE SEALS AND FITTED WITH A SELF-CLOSING DEVICE.
  - ILLUMINATED SIGN INDICATING FIRE EXIT
  - FIRE EXIT WITH PUSH BAR/PAD OPENING WITH SIGN
- MEANS OF ESCAPE**  
Fire doors to be half hour fire resisting and self closing. Doors to satisfy BS719 Part 22: 1987 and be FD30/30 standard. Doors protecting means of escape should be fitted with intumescent strips and cold smoke seals.
- FIRE ALARM**  
To integrate with provided building system. Symbols on plan indicate rooms to be covered, and actual location of detector heads are to be advised by a specialist fire alarm consultant.
- FIRE FIGHTING EQUIPMENT**  
All fire fighting equipment to be set so that the carry handles are located 1.5m above floor level.  
All equipment to be subject to annual testing by a competent person.
- EMERGENCY LIGHTING**  
Premises to be covered with emergency lighting to standard set out in BS 5266, Part 1:2002. The code of practice for the emergency lighting of premises other than cinemas.  
All exits to be indicated by the use of maintained illuminated exit signs. All other areas to be illuminated by general emergency lighting.
- CCTV  
Cctv locations to be agreed with the crime prevention team.

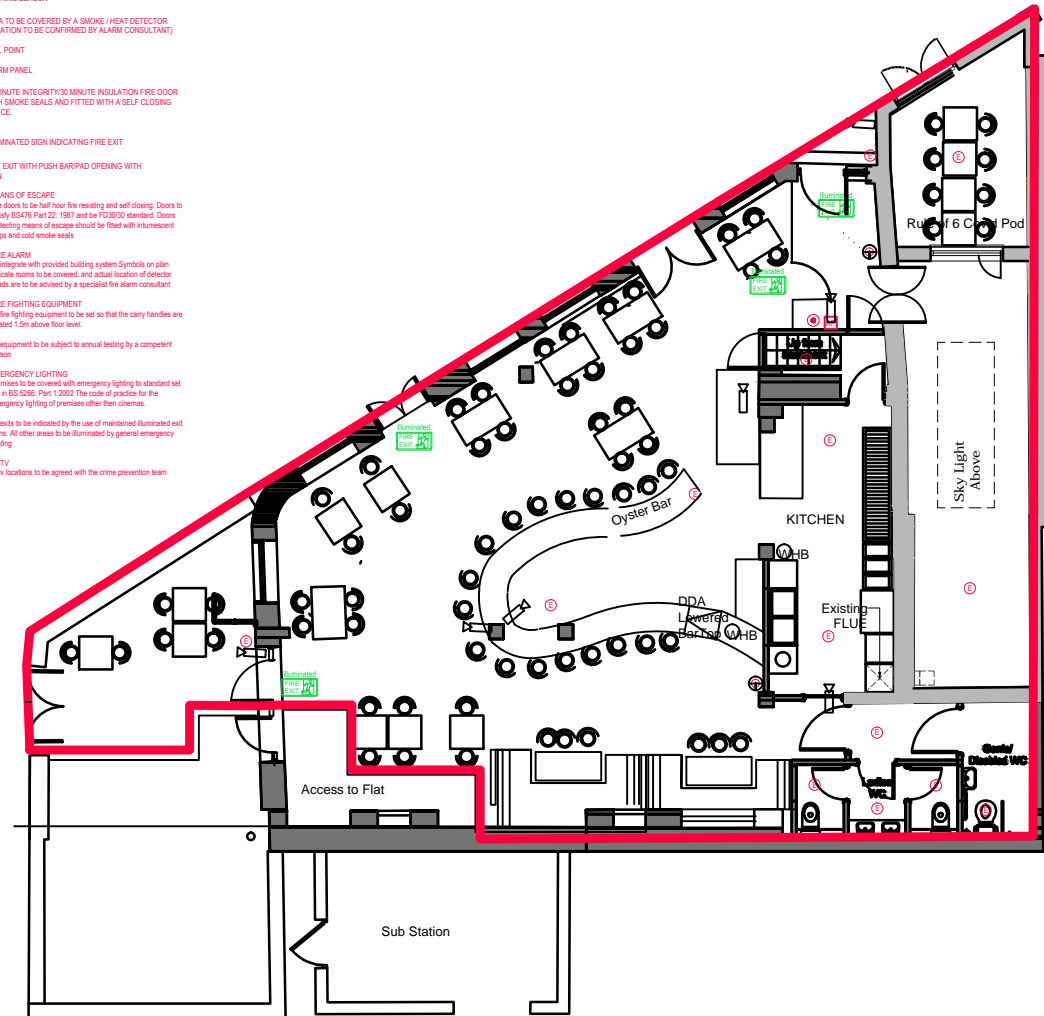

**Notes**

- 1- This drawing is not for construction
- 2- All Dimension are in millimeters
- 3- Dimensions are not to be scaled directly from drawings
- 4- All dimensions are to be checked on site and the Architect is to be inform of any discrepancies before construction commences
- 5- All references to drawings refer to current revision of that drawing

scale 1:100

Rev.	Date	Revisions
<b>FOR LICENSING</b>		
<b>GMP STUDIOS</b>		
ARCHITECTURAL DESIGN STUDIO 33B Grand Parade, Green Lanes, Haringey, London, N4 1LG Tel: 0208 609 2320 - 0784241 0527 Web: www.archpl.co.uk		
Client <b>15 Highgate Road, NW5 1QX</b>		Victoria Sharples
Scale 1/100@ A3	Date 04/2021	
Drawn By NM	Checked By NM	
Project No. 1369	Drawing No. 001	Revision B
Drawing title <b>Proposed Ground Floor Plan</b>		