

Application for a premises licence to be granted under the Licensing Act 2003

PLEASE READ THE FOLLOWING INSTRUCTIONS FIRST

Before completing this form please read the guidance notes at the end of the form. If you are completing this form by hand please write legibly in block capitals. In all cases ensure that your answers are inside the boxes and written in black ink. Use additional sheets if necessary.

You may wish to keep a copy of the completed form for your records.

We London and Soho Stores Limited

(Insert name(s) of applicant)

apply for a premises licence under section 17 of the Licensing Act 2003 for the premises described in Part 1 below (the premises) and I/we are making this application to you as the relevant licensing authority in accordance with section 12 of the Licensing Act 2003

Part 1 – Premises details

Postal address of premises or, if none, ordnance survey map reference or description			
London and Soho Stores 88 Charing Cross Road			
Post town	London	Postcode	WC2H 0JA
Telephone number at premises (if any)			
Non-domestic rateable value of premises		£ 43,250	

Part 2 - Applicant details

Please state whether you are applying for a premises licence as **Please tick as appropriate**

- | | |
|--|-----------------------------|
| a) an individual or individuals * | please complete section (A) |
| b) a person other than an individual * | |
| i as a limited company/limited liability partnership <input checked="" type="checkbox"/> | please complete section (B) |
| ii as a partnership (other than limited liability) | please complete section (B) |
| iii as an unincorporated association or | please complete section (B) |
| iv other (for example a statutory corporation) | please complete section (B) |
| c) a recognised club | please complete section (B) |
| d) a charity | please complete section (B) |
| e) the proprietor of an educational establishment | please complete section (B) |

- f) a health service body please complete section (B)
- g) a person who is registered under Part 2 of the Care Standards Act 2000 (c14) in respect of an independent hospital in Wales please complete section (B)
- ga) a person who is registered under Chapter 2 of Part 1 of the Health and Social Care Act 2008 (within the meaning of that Part) in an independent hospital in England please complete section (B)
- h) the chief officer of police of a police force in England and Wales please complete section (B)

* If you are applying as a person described in (a) or (b) please confirm (by ticking yes to one box below):

I am carrying on or proposing to carry on a business which involves the use of the premises for licensable activities; or

I am making the application pursuant to a
 statutory function or
 a function discharged by virtue of Her Majesty's prerogative

(A) INDIVIDUAL APPLICANTS (fill in as applicable)

Mr	Mrs	Miss	Ms	Other Title (for example, Rev)	
Surname			First names		
Date of birth		I am 18 years old or over		Please tick yes	
Nationality					
Current residential address if different from premises address					
Post town				Postcode	
Daytime contact telephone number					
E-mail address (optional)					
Where applicable (if demonstrating a right to work via the Home Office online right to work checking service), the 9-digit 'share code' provided to the applicant by that service (please see note 15 for information)					

SECOND INDIVIDUAL APPLICANT (if applicable)

Mr	Mrs	Miss	Ms	Other Title (for example, Rev)	
Surname			First names		
Date of birth		I am 18 years old or over		Please tick yes	
Nationality					
Where applicable (if demonstrating a right to work via the Home Office online right to work checking service), the 9-digit 'share code' provided to the applicant by that service: (please see note 15 for information)					
Current residential address if different from premises address					
Post town				Postcode	
Daytime contact telephone number					
E-mail address (optional)					

(B) OTHER APPLICANTS

Please provide name and registered address of applicant in full. Where appropriate please give any registered number. In the case of a partnership or other joint venture (other than a body corporate), please give the name and address of each party concerned.

Name London and Soho Stores Ltd
Address 80 Carrington Road High Wycombe. HP12 3HT
Registered number (where applicable) 12382332
Description of applicant (for example, partnership, company, unincorporated association etc.) Limited Company

Telephone number (if any) <input type="text"/>
E-mail address (optional) <input type="text"/>

Part 3 Operating Schedule

When do you want the premises licence to start?

DD	MM	YYYY
<input type="text"/>	<input type="text"/>	<input type="text"/>

If you wish the licence to be valid only for a limited period, when do you want it to end?

DD	MM	YYYY
<input type="text"/>	<input type="text"/>	<input type="text"/>

Please give a general description of the premises (please read guidance note 1)

Convenience Store

If 5,000 or more people are expected to attend the premises at any one time, please state the number expected to attend.

What licensable activities do you intend to carry on from the premises?

(please see sections 1 and 14 and Schedules 1 and 2 to the Licensing Act 2003)

Provision of regulated entertainment (please read guidance note 2)

Please tick all that apply

- a) plays (if ticking yes, fill in box A)
- b) films (if ticking yes, fill in box B)
- c) indoor sporting events (if ticking yes, fill in box C)
- d) boxing or wrestling entertainment (if ticking yes, fill in box D)
- e) live music (if ticking yes, fill in box E)
- f) recorded music (if ticking yes, fill in box F)
- g) performances of dance (if ticking yes, fill in box G)
- h) anything of a similar description to that falling within (e), (f) or (g) (if ticking yes, fill in box H)

Provision of late night refreshment (if ticking yes, fill in box I)

Supply of alcohol (if ticking yes, fill in box J)

In all cases complete boxes K, L and M

A

Plays Standard days and timings (please read guidance note 7)			<u>Will the performance of a play take place indoors or outdoors or both – please tick</u> (please read guidance note 3)	Indoors	
Day	Start	Finish		Outdoors	
				Both	
Mon			<u>Please give further details here</u> (please read guidance note 4)		
Tue					
Wed			<u>State any seasonal variations for performing plays</u> (please read guidance note 5)		
Thur					
Fri			<u>Non standard timings. Where you intend to use the premises for the performance of plays at different times to those listed in the column on the left, please list</u> (please read guidance note 6)		
Sat					
Sun					

B

Films Standard days and timings (please read guidance note 7)			<u>Will the exhibition of films take place indoors or outdoors or both – please tick</u> (please read guidance note 3)	Indoors	
Day	Start	Finish		Outdoors	
Mon				<u>Please give further details here</u> (please read guidance note 4)	
Tue					
Wed			<u>State any seasonal variations for the exhibition of films</u> (please read guidance note 5)		
Thur					
Fri			<u>Non standard timings. Where you intend to use the premises for the exhibition of films at different times to those listed in the column on the left, please list</u> (please read guidance note 6)		
Sat					
Sun					

C

Indoor sporting events Standard days and timings (please read guidance note 7)			<u>Please give further details</u> (please read guidance note 4)
Day	Start	Finish	
Mon			
Tue			<u>State any seasonal variations for indoor sporting events</u> (please read guidance note 5)
Wed			
Thur			<u>Non standard timings. Where you intend to use the premises for indoor sporting events at different times to those listed in the column on the left, please list</u> (please read guidance note 6)
Fri			
Sat			
Sun			

D

Boxing or wrestling entertainments Standard days and timings (please read guidance note 7)			<u>Will the boxing or wrestling entertainment take place indoors or outdoors or both – please tick</u> (please read guidance note 3)	Indoors	
Day	Start	Finish		Outdoors	
Mon				<u>Please give further details here</u> (please read guidance note 4)	
Tue					
Wed			<u>State any seasonal variations for boxing or wrestling entertainment</u> (please read guidance note 5)		
Thur					
Fri			<u>Non standard timings. Where you intend to use the premises for boxing or wrestling entertainment at different times to those listed in the column on the left, please list</u> (please read guidance note 6)		
Sat					
Sun					

E

Live music Standard days and timings (please read guidance note 7)			<u>Will the performance of live music take place indoors or outdoors or both – please tick</u> (please read guidance note 3)	Indoors				
				Outdoors				
				Both				
Day	Start	Finish	<u>Please give further details here</u> (please read guidance note 4)					
Mon								
Tue								
Wed						<u>State any seasonal variations for the performance of live music</u> (please read guidance note 5)		
Thur								
Fri						<u>Non standard timings. Where you intend to use the premises for the performance of live music at different times to those listed in the column on the left, please list</u> (please read guidance note 6)		
Sat								
Sun								

F

Recorded music Standard days and timings (please read guidance note 7)			<u>Will the playing of recorded music take place indoors or outdoors or both – please tick</u> (please read guidance note 3)	Indoors	
Day	Start	Finish		Outdoors	
Mon				<u>Please give further details here</u> (please read guidance note 4)	
Tue					
Wed			<u>State any seasonal variations for the playing of recorded music</u> (please read guidance note 5)		
Thur					
Fri			<u>Non standard timings. Where you intend to use the premises for the playing of recorded music at different times to those listed in the column on the left, please list</u> (please read guidance note 6)		
Sat					
Sun					

G

Performances of dance Standard days and timings (please read guidance note 7)			<u>Will the performance of dance take place indoors or outdoors or both – please tick</u> (please read guidance note 3)	Indoors	
Day	Start	Finish		Outdoors	
Mon				<u>Please give further details here</u> (please read guidance note 4)	Both
Tue					
Wed			<u>State any seasonal variations for the performance of dance</u> (please read guidance note 5)		
Thur					
Fri			<u>Non standard timings. Where you intend to use the premises for the performance of dance at different times to those listed in the column on the left, please list</u> (please read guidance note 6)		
Sat					
Sun					

H

Anything of a similar description to that falling within (e), (f) or (g) Standard days and timings (please read guidance note 7)			Please give a description of the type of entertainment you will be providing		
Day	Start	Finish	<u>Will this entertainment take place indoors or outdoors or both – please tick</u> (please read guidance note 3)	Indoors	
Mon				Outdoors	
				Both	
Tue			<u>Please give further details here</u> (please read guidance note 4)		
Wed					
Thur			<u>State any seasonal variations for entertainment of a similar description to that falling within (e), (f) or (g)</u> (please read guidance note 5)		
Fri					
Sat			<u>Non standard timings. Where you intend to use the premises for the entertainment of a similar description to that falling within (e), (f) or (g) at different times to those listed in the column on the left, please list</u> (please read guidance note 6)		
Sun					

I

Late night refreshment Standard days and timings (please read guidance note 7)			Will the provision of late night refreshment take place indoors or outdoors or both – please tick (please read guidance note 3)	Indoors	
Day	Start	Finish		Outdoors	
Mon				<u>Please give further details here</u> (please read guidance note 4)	
Tue					
Wed			<u>State any seasonal variations for the provision of late night refreshment</u> (please read guidance note 5)		
Thur					
Fri			<u>Non standard timings. Where you intend to use the premises for the provision of late night refreshment at different times, to those listed in the column on the left, please list</u> (please read guidance note 6)		
Sat					
Sun					

J

Supply of alcohol Standard days and timings (please read guidance note 7)			Will the supply of alcohol be for consumption – please tick (please read guidance note 8)	On the premises	
				Off the premises	<input checked="" type="checkbox"/>
				Both	
Day	Start	Finish	State any seasonal variations for the supply of alcohol (please read guidance note 5)		
Mon	0600	2300			
Tue	0600	2300			
Wed	0600	2300			
Thur	0600	2300			
Fri	0600	2300			
Sat	0600	2300			
Sun	0600	2300			
			Non standard timings. Where you intend to use the premises for the supply of alcohol at different times to those listed in the column on the left, please list (please read guidance note 6)		

State the name and details of the individual whom you wish to specify on the licence as designated premises supervisor (Please see declaration about the entitlement to work in the checklist at the end of the form):

Name Mr Bharatkumar Modh	
Date of birth [REDACTED]	
Address [REDACTED] [REDACTED] [REDACTED]	
Postcode	[REDACTED]
Personal licence number (if known) [REDACTED]	
Issuing licensing authority (if known) [REDACTED]	

K

Please highlight any adult entertainment or services, activities, other entertainment or matters ancillary to the use of the premises that may give rise to concern in respect of children (please read guidance note 9).

None

L

<p>Hours premises are open to the public Standard days and timings (please read guidance note 7)</p>			<p><u>State any seasonal variations</u> (please read guidance note 5)</p>
Day	Start	Finish	
Mon	0600	2300	
Tue	0600	2300	
Wed	0600	2300	
Thur	0600	2300	
Fri	0600	2300	
Sat	0600	2300	
Sun	0600	2300	<p><u>Non standard timings. Where you intend the premises to be open to the public at different times from those listed in the column on the left, please list</u> (please read guidance note 6)</p>

M

Describe the steps you intend to take to promote the four licensing objectives:

a) General – all four licensing objectives (b, c, d and e) (please read guidance note 10)

1. There shall be CCTV in Operation signs prominently displayed.
2. All instances of crime or disorder to be reported by the designated premises supervisor or responsible member of staff.
3. Fire extinguishers and fire alarm is installed.
4. All alcohol shall be sold in sealed containers. They shall not be opened or consumed in or within the vicinity of the premises.
5. Where the sale or supply of alcohol is taking place employees of the premises must request sight of evidence of the age of any person appearing to be under 25 years of age (Challenge 25).
6. The premises will display prominent signage by every entrance and exit requesting customers to leave the premises quietly and respect local residents

b) The prevention of crime and disorder

As Above

c) Public safety

As Above

d) The prevention of public nuisance

As Above

e) The protection of children from harm

As Above

Checklist:

Please tick to indicate agreement

- I have made or enclosed payment of the fee.
- I have enclosed the plan of the premises.
- I have sent copies of this application and the plan to responsible authorities and others where applicable.
- I have enclosed the consent form completed by the individual I wish to be designated premises supervisor, if applicable.
- I understand that I must now advertise my application.
- I understand that if I do not comply with the above requirements my application will be rejected.
- [Applicable to all individual applicants, including those in a partnership which is not a limited liability partnership, but not companies or limited liability partnerships] I have included documents demonstrating my entitlement to work in the United Kingdom or my share code issued by the Home Office online right to work checking service (please read note 15).

IT IS AN OFFENCE, UNDER SECTION 158 OF THE LICENSING ACT 2003, TO MAKE A FALSE STATEMENT IN OR IN CONNECTION WITH THIS APPLICATION. THOSE WHO MAKE A FALSE STATEMENT MAY BE LIABLE ON SUMMARY CONVICTION TO A FINE OF ANY AMOUNT.

IT IS AN OFFENCE UNDER SECTION 24B OF THE IMMIGRATION ACT 1971 FOR A PERSON TO WORK WHEN THEY KNOW, OR HAVE REASONABLE CAUSE TO BELIEVE, THAT THEY ARE DISQUALIFIED FROM DOING SO BY REASON OF THEIR IMMIGRATION STATUS. THOSE WHO EMPLOY AN ADULT WITHOUT LEAVE OR WHO IS SUBJECT TO CONDITIONS AS TO EMPLOYMENT WILL BE LIABLE TO A CIVIL PENALTY UNDER SECTION 15 OF THE IMMIGRATION, ASYLUM AND NATIONALITY ACT 2006 AND PURSUANT TO SECTION 21 OF THE SAME ACT, WILL BE COMMITTING AN OFFENCE WHERE THEY DO SO IN THE KNOWLEDGE, OR WITH REASONABLE CAUSE TO BELIEVE, THAT THE EMPLOYEE IS DISQUALIFIED.

Part 4 – Signatures (please read guidance note 11)

Signature of applicant or applicant’s solicitor or other duly authorised agent (see guidance note 12). **If signing on behalf of the applicant, please state in what capacity.**

Declaration	<ul style="list-style-type: none"> • [Applicable to individual applicants only, including those in a partnership which is not a limited liability partnership] I understand I am not entitled to be issued with a licence if I do not have the
--------------------	---

	<p>entitlement to live and work in the UK (or if I am subject to a condition preventing me from doing work relating to the carrying on of a licensable activity) and that my licence will become invalid if I cease to be entitled to live and work in the UK (please read guidance note 15).</p> <ul style="list-style-type: none"> The DPS named in this application form is entitled to work in the UK (and is not subject to conditions preventing him or her from doing work relating to a licensable activity) and I have seen a copy of his or her proof of entitlement to work, or have conducted an online right to work check using the Home Office online right to work checking service which confirmed their right to work (please see note 15)
Signature	B NAKUM
Date	23 July 2021
Capacity	Authorised Agent

For joint applications, signature of 2nd applicant or 2nd applicant's solicitor or other authorised agent (please read guidance note 13). **If signing on behalf of the applicant, please state in what capacity.**

Signature	
Date	
Capacity	

Contact name (where not previously given) and postal address for correspondence associated with this application (please read guidance note 14)			
Bobby Nakum Lifestyle Express Beachley Road			
Post town	Tutshill	Postcode	██████7DJ
Telephone number (if any)	██████████		
If you would prefer us to correspond with you by e-mail, your e-mail address (optional)			
██████████@██████████.com			

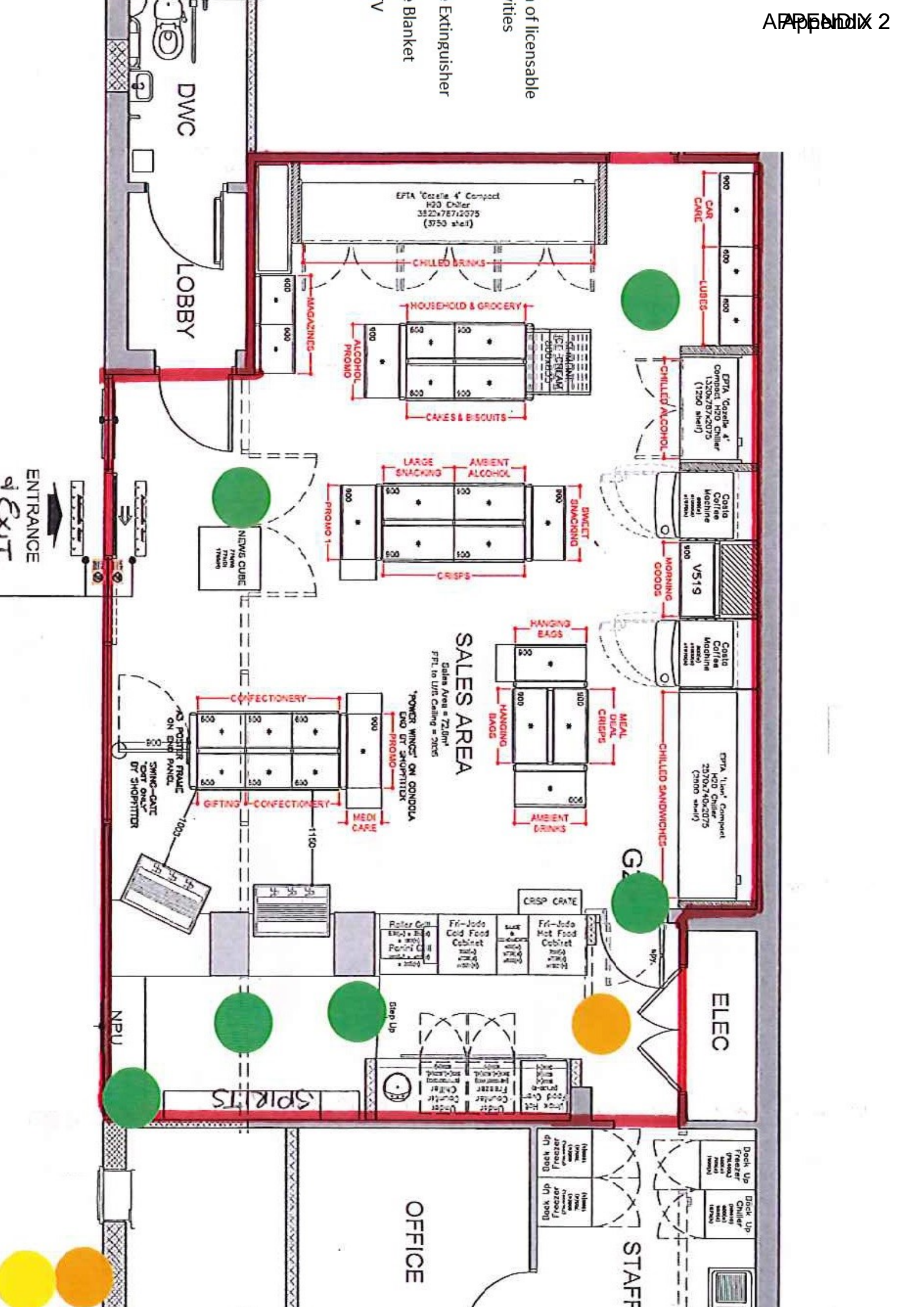

ities
of licensable
Extinguisher
Blanket

DWC

LOBBY

EFTA 'Gazelle 4' Compact
H2O Chiller
3520x767x2075
(3750 shelf)

CHILLED BRINKS

HOUSEHOLD & GROCERY

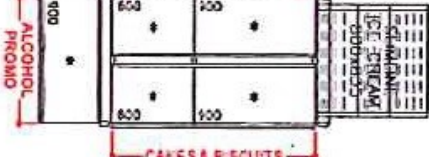

LARGE SNACKING

AMBIENT ALCOHOL

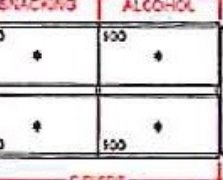

CRISPS

DWELT SNACKING

HANGING BAGS

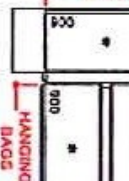

AMBIENT DRINKS

SALES AREA

Sales Area = 72.8m²
FPL to Unit Ceiling = 21m

POWER WINDOW ON CONDUIT
END OF SHOPFITTER

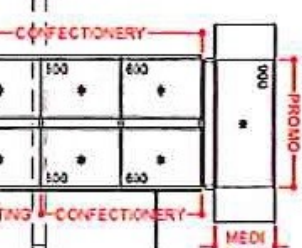

CONFECTIONERY

GIFTING CONFECTIONERY

MEDI CARE

ELEC

OFFICE

STAFF

NPU

SPRINKLES

EFTA 'Lion' Compact
H2O Chiller
2570x2740x2075
(3700 shelf)

CHILLED SANDWICHES

CHILLED ALCOHOL

MORNING GOODS

MEAL DEAL CRISPS

CRISP CRATE

FRIDGE

FRIDGE

FRIDGE

FRIDGE

FRIDGE

CAR CARE

LUBES

CHILLED ALCOHOL

CHILLED ALCOHOL

CHILLED ALCOHOL

CHILLED ALCOHOL

CHILLED ALCOHOL

CHILLED ALCOHOL

CHILLED ALCOHOL

CHILLED ALCOHOL

CHILLED ALCOHOL

CHILLED ALCOHOL

CHILLED ALCOHOL

CHILLED ALCOHOL

CHILLED ALCOHOL

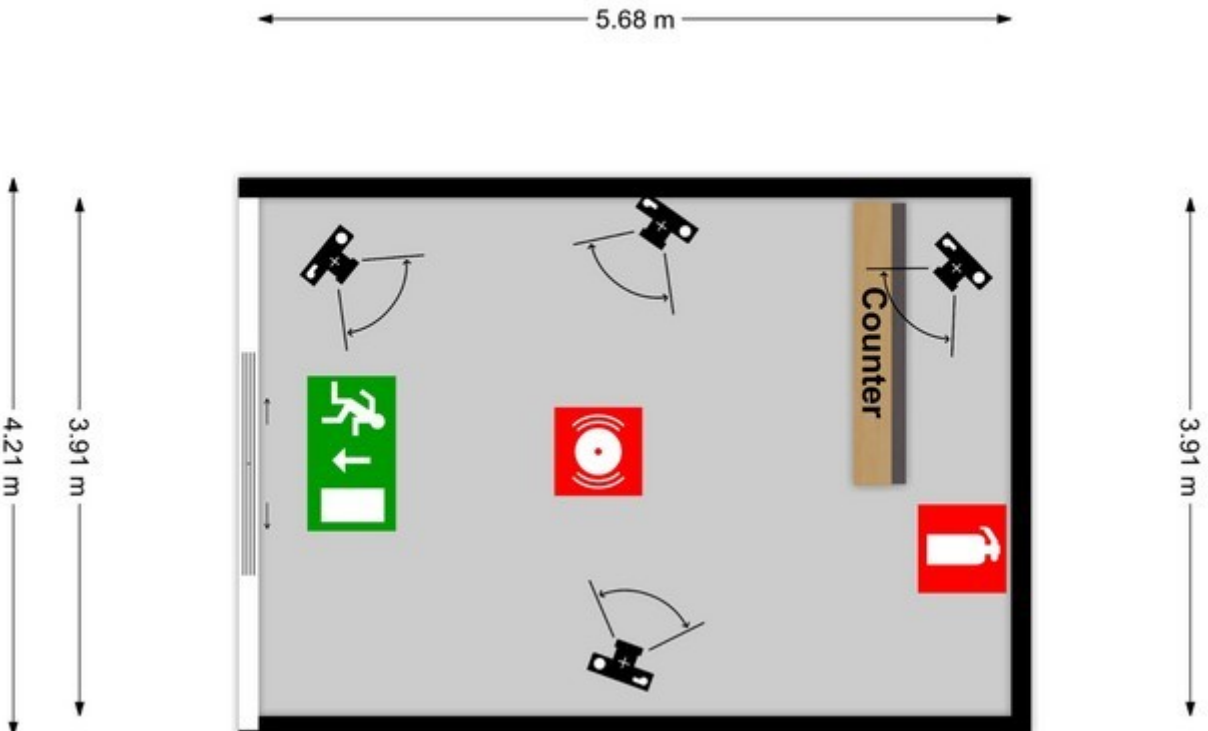

Fire Alarm

CCTV

Fire Extinguisher

Scale 1:100



**METROPOLITAN
POLICE**

TOTAL POLICING

Camden Licensing Authority

Town Hall Extension
Argyle St
London

WC1H 8EQ

EK - Camden Borough

Licensing Unit
Room 1.22
Kentish Town Police Station
12a Holmes Rd
London
NW5 3AE

Telephone: 020 8733 6326

Email:
Christopher.Malone@met.pnn.police.uk

Your ref: **NEW/105946**

19th August 2021

Dear Sir/Madam

RE: Application NEW/105946

London Soho Stores Ltd, 88 Charing Cross Road London WC2H 0JA

With reference to the above Application, the **Metropolitan Police Service (MPS) wishes to make a Representation**.

Within the Licensing Act 2003, and contained in the notes for guidance for the Licensing Act 2003, it is the responsibility of the Police and Local Authority to promote the Prevention of Crime and Disorder, Promote Public Safety, Prevent Public Nuisance and Protect Children from Harm.

I certify that I have considered the application above, and my representation is based on the likely effect of the grant of the application being detrimental to Camden Council's Licensing Objectives for the reasons contained within the content of this document. I am of the opinion that the risk to Camden Council's objectives can be mitigated by the MPS' recommended times and conditions being appended onto any granted premises licence.

This Application is based within one of Camden's Cumulative Impact Zones (CIZ) and therefore there is a presumption, based on the Borough Council's own Licensing Policy, that any New or Variation Application will be refused; due to the effects of cumulative impact. The MPS supports the Policy, especially in respect of the impact to Alcohol Harm. Camden Borough has the 4th largest Night Time Economy in the UK (source: *Night Mix Index, Make Associates*)

Health, Crime and Social Impacts

The Institute of Alcohol Studies brings together evidence and policy to promote an informed debate on alcohol's impact on society.

- **According to the World Health Organisation (WHO), the harmful use of alcohol results in 3.3 million deaths every year. Overall, 5.1% of the global burden of disease and injury is attributable to alcohol.**
- **Alcohol consumption causes death and disability relatively early in life. In the age groups of 20-39 year olds, approximately 25% of deaths are alcohol attributable. (Updated February 2018)**
- **Alcohol related crime makes up a substantial portion of violent offences across the UK (47% in England and Wales in 2014/15)**
- **An IAS study found 75% of Police Officers and 50% of Paramedics have been injured in alcohol related incidents. Furthermore, 43% of service personnel have suffered sexual harassment or abuse at the hands of intoxicated members of the public.**

(Source: *Institute of Alcohol Studies, Economic Impacts of Alcohol Factsheet, October 2015*)

Unique Application Issues

Of concern to the MPS is the venue's wish to offer off sales of alcohol in this already saturated area of off licences, Public Houses and night clubs. Charing Cross Road borders Westminster Borough (Soho) which makes this combined area the busiest night time economy in the UK.

This venue is in a Cumulative Impact Zone and will add to the drinking on the street and people preloading throughout the night before entering other licenced venues. The MPS have concerns relating to alcohol related violence that mainly occur in the streets, so much so that the Seven Dials Cumulative Impact Zone has one of highest rates of alcohol related incidents on Camden Borough. Over the years (except last year through Covid), the MPS have noticed that violence inside on-licenced venues is far less than what occurs on the street, therefore the MPS feel that this venue will contribute to crime and disorder figures and public nuisance.

From seeing the negative impact that alcohol has on its community, the MPS would look to refuse this application altogether.

The Seven Dials area houses and supports street drinkers and alcoholics, therefore adding another off licence to this already saturated area will add to the strain of emergency services by having to deal with drunks and making alcohol more accessible to people that are addicted. Westminster Borough and Camden Borough have noticed pre covid a large increase in street population and to cope with living on the street, these people turn to drugs and or alcohol to cope. The venue is situated within the Seven Dials 'Cumulative Impact Area' an intense area of crime and anti-social behaviour, particularly in relation to the Night Time Economy. Police resources become heavily drained during the relevant times. A New Premises Licence will add to the cumulative impact of footfall in the area and is likely to contribute to alcohol-related crime and disorder; whether by suspects or victims.

If you look at the venues plan or layout, the shop is only 5.68 metres deep by 3.91 meters wide. On the plan they have not stipulated or shown where the alcohol will be shelved or stored, but have only shown that there will be CCTV and has a fire alarm. Secondly the applicant has been very vague and stated that this will be a convenient store. I suspect as the shop is so small it will predominantly be stocked with alcohol. Also being in a Cumulative Impact Zone, the applicant has only offered a few conditions which will not address the licensing objectives.

Another concern is that the applicant has applied to sell alcohol as early as 0600 hours in the morning. This is very irresponsible as it will mostly target clubbers on route home and people dependant on alcohol and the street population, indicating that the applicant does not understand the area a licence is being applied for with all the alcohol related concerns in this community.

On Thursday, Friday, Saturday and Bank Holiday Sunday nights, this venue will be an alcohol led establishment due to the fact the clientele are in the area to attend other venues for recreation. Pre-loading is seen too frequently on the streets of London.

Customers will only be inside off licences for short periods of time and therefore the shop workers do not generally see the alcohol related violence that occurs on the streets of London once customers leave their venues, especially in this area which has a vibrant street night life.

The area this application is sort, has a large residential population too and the concern is that this will add to alcohol related crime and disorder, alcohol related dependency issues in dwellings and on the streets.

Off sales of alcohol will add to crime and disorder, litter and anti-social behaviour. Customers are inside off licences for short amounts of time, with the shop worker not knowing where the alcohol will be consumed, whether on the streets by alcohol dependant people, people that preload before attending venues. They generally do not see the alcohol related violence that occurs in on the streets of London once customers leave their venues, especially in this area which has a vibrant street night life.

Research and Intelligence

A review of crime figures, intelligence reports, and Police Licensing visits over the past 12 months, shows that there were 102 crimes along Charing Cross Road on Camden Borough. This is high as venues have only recently opened properly without covid restrictions. Crimes range from Sexual assault, theft, Common Assault, Public Disorder Offences, Drugs, Grievous Bodily Harm, Poisoning (Drink Spiking) and Actual Bodily Harm to name a few.

During lockdown crime reports for Charing Cross Road, starting on 21st March 2020 to 21st March 2021 there were only 94 crime reports on Camden Borough.

To show you how busy Charing Cross Road is when the night time economy is in full swing and before Covid restrictions, a search of the crime figure along Charing Cross Road from 21st March 2019 to the 21st March 2020, shows that 319 crimes occurred on Camden Borough. This is one street which is part of Camden's CIZ, so cumulatively the crime figures would be extremely high.

Bearing in mind that this location is bordered by Westminster, and that the offences shown are those that have occurred in the borough of Camden.

It is apparent that these figures have been significantly influenced by the current pandemic we find ourselves in.

Any Licensing Hearing held as a result of this Representation may be supplied with further, specific, crime figures and intelligence reports relating to the venue or the area in which it is located.

Times and Conditions Offered/Recommended

For clarity, the MPS supports Camden Council's Licensing Policy with regards to the presumption to refuse New or Variation Applications within a Special Policy area.

The MPS would recommend this application be refused in its entirety as it will contribute to crime and disorder on the streets of London. Mindful however, that the Applicant may successfully rebut the policy; or the Panel decides of its own volition to grant the Application, the MPS would strongly recommend the Panel consider imposing the following Times and Conditions on any granted Application:

Times Applied for:

Monday to Sunday 0600 to 2300 hours

Times Recommended:

Monday to Wednesday 0800 – 2300 hours

Friday Saturday and Bank Holiday Sundays 1000 – 1800 hours

Sundays 1000 – 2230 hours

Conditions:

The MPS does acknowledge the 6 conditions offered by the Applicant. However, Police Licensing are not convinced that these conditions alone will adequately uphold the Licensing objectives:

Condition 5 offered by the applicant:

Where the sale or supply of alcohol is taking place employees of the premises must request sight of evidence of the age of any person appearing to be under 25 years of age (Challenge 25).

Condition recommended by Police to replace condition 5:

A Challenge 25 policy will be enforced, where any person reasonably looking under the age of 25 shall be asked to prove their age when attempting to purchase alcohol and signs to this effect will be displayed at the premises. The only acceptable forms of identity will be those with photographic identification documents recognised in the Home Office guidance; including passports, photo-card driving licence or proof of age card bearing the PASS hologram

Extra Conditions recommended if a licence is granted:**CCTV**

- 1.) CCTV shall be installed, operated, and maintained, to function all times that the premises is open for licensable activities. Said CCTV will comply with the following criteria:
 - (a) The licensee will ensure that the system is checked every two weeks to ensure that the system is working properly and that the date and time are correct;
 - (b) A record of these checks, showing the date and name of the person checking, will be kept and made available to the police or other authorised officer on request;
 - (c) The Police will be informed if the system will not be operating for longer than one day of business for any reason;
 - (d) The system will record in real time and recordings will be date and time stamped;
 - (e) Recordings will be kept for a minimum of 31 days and downloaded footage will be provided free of charge to the police or other authorised officers on request (subject to the Data Protection Act requirements) within 48 hours of any request.
 - (e) CCTV to cover all entry and exit points of the building.
 - (f) CCTV will be of good quality, a standard approved by the police/council licensing officers.

LICENSING LAW & INCIDENT MANAGEMENT

- 2.) The licensee will ensure that staff are trained, as appropriate, in respect of relevant Licensing Law; crime scene best practice and upon the sale of alcohol to drunks and to persons underage
- 3) Police must be called to incidents of violence and/or disorder where appropriate.
- 4) The premises licence holder shall not sell super strength beer, lager or cider with an alcohol content above 5.5% ABV or greater. This restriction shall not apply in respect of specialist branded premium priced products, for example Craft ales, local or micro-brewery specialist products, boxed gifts or national celebratory/commemorative beer, lager or cider with alcohol content of 5.5% ABV or greater.
- 5) All alcohol in the public parts of the premises shall be kept in display units. All display units for alcohol will have metal shutters.

- 6) Shutters will be locked at the end of permitted hours for the sale of alcohol and shall not be opened again until the start of permitted hours the following day.
- 7) No lagers or ciders in cans or plastic bottles over 5.5% ABV to be sold or stored on the premises.
- 8) All alcohol products sold to be clearly marked with the name of the store.
- 9) A personal licence holder to be present at the venue at all times when the venue is open during licensed hours.
- 10) Alcohol shall not be sold in an open container, be opened in the premises, or be consumed in the premises.
- 11) A visible sign to be in place reminding customers that Camden Borough is a Controlled Drinking Zone and alcohol must not be consumed in the street.
- 12) A sign shall be displayed at the point of sale stating "No Proof of Age - No Sale".
- 13) After 1600hrs daily, a minimum of 2 members of staff to be present at all times whilst the premises remain open.
- 14) An incident book/refusal book to be maintained and ready for immediate Police and Council inspection, upon request.
- 15) No alcohol to be stored beneath the serving counters at any time.
- 16) All products to be paid for in full at the point of sale. No 'credit' to be offered to any customers.

PURCHASE OF ALCOHOL BY VENUE

- 17) The Premises Licence Holder and Designated Premises Licence Holder shall ensure alcohol is only purchased from an authorised wholesaler and shall produce receipts for the same upon request for inspection. (An authorised wholesaler means an established warehouse or trade outlet with a fixed address and not a van or street trader, even if they claim they are part of, or acting on behalf of, an authorised wholesaler who provides full itemised VAT receipts).
- 18) The Premises Licence Holder shall ensure all receipts for alcohol goods purchased include the following details:
 - I. Seller's name and address
 - II. Seller's company details, if applicable
 - III. Seller's VAT details, if applicable
 - IV. Vehicle registration detail, if applicable
- 19) Legible copies of the documents referred to in Condition **17** above shall be retained on the premises and made available for inspection by Police and authorised Council Officers on request.
- 20) Copies of the documents referred to in Condition **17** above shall be retained on the premises for period of not less than twelve months.
- 21) Where the trader becomes aware that any alcohol may be not duty paid they shall inform the Police of this immediately.

In summary, the view of the MPS is that this Application **should be rejected in its entirety**. However if a licence is granted the above times and conditions are added to the licence.

Yours sincerely,

Pc Chris Malone
Police Licensing Officer
Licensing Officer.
Kentish Town Police Station,
12a Holmes Road

Date: 11 August 2021
Application Reference: APP\PREMISES-NEW105946
020 7974 6978
Direct Phone Number: Julia Peterson
Contact: julia.peterson@camden.gov.uk
E-mail:



Public Protection
 London Borough of Camden
 Town Hall Judd St
 London WC1H 9JE

Tel: 020 7974 4444 (switchboard)
 London Borough of Camden
 Fax: 020 7974 6955 / 6940
 Textphone: 020 7974 6866
 Town Hall DX: 2106 Euston

www.camden.gov.uk

Please quote our reference in any correspondence

Licensing (Contact Camden)
 Town Hall Extension
 Argyle Street
 London
 WC1H 8EQ

Licensing Act 2003

– **Re: London and Soho Stores 88 Charing Cross Road London WC2H 0JA**

LICENSING AUTHORITY REPRESENTATION

This representation is made by the Licensing Authority and it relates to the following Licensing Objectives:

- The prevention of public nuisance

The Premises and Summary of Application

The premises are described as a Convenience Store, the application is to carry out the following activities:

- Sale of Alcohol (off sales)

The times being applied for are as follows:

- Monday to Sunday 06:00 until 23:00

Framework Hours Policy

The hours being applied for are beyond the framework hours for premises carrying out off sales only, these are:

Monday to Saturday 08:00 until 23:00
 Sunday 10:00 until 22:30

Cumulative Impact Areas

The premises are situated in the Seven Dials Cumulative Impact Policy area where there is a presumption to refuse all new and variation applications, as set out in Chapter Six of the Licensing Policy (Cumulative Impact Policies). While this presumption is rebuttable, this is only in exceptional circumstances and where the applicant has successfully demonstrated that the granting of their application would not contribute to the existing impact of licensed premises in that area.

The applicant has provided a number of conditions to promote the licensing objectives, however, even with these conditions, granting the application will result in an overall increase in capacity at licensed premises in the area, which could lead to additional people being on the street and add to the cumulative impact in the area

Complaint History

There is no history of complaints at this premises within the past two years.

Summary of Action Taken

N/A

Conclusion

The application is for a licensable activity to be provided beyond the framework hours at a premises situated in the Seven Dials Cumulative Impact Area and therefore the presumption is that it should be refused in its entirety.

Yours sincerely

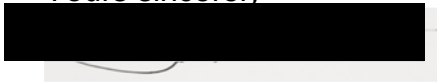
A black rectangular redaction box covering the signature of the sender.

Julia Peterson
Licensing Enforcement Officer

Representation	
Premises name	London and Soho Stores
Application reference number	APP\PREMISES-NEW\105946
Last date for representation	23/08/2021

Making a representation as

As an individual

Your details**First name**

Joseph

Last name

Farrell

Telephone number (optional)**Email address**

[REDACTED]m

AddressFlat 11 Trentishoe Mansions
90 Charing Cross Road
London
WC2H 0JE**Remain anonymous**

No

Grounds of representation

- prevention of crime and disorder
- ensuring public safety
- prevention of public nuisance

Details of representation

I am a resident in the same building as this shop. It is a cumulative impact area and is one of London's busiest streets. One door away from us is a night club where people spill out drunk all day long. And right opposite is a pub where this happens too. In other words we already have a significant amount of drunk and disorderly people in the area. The area also has many off licences not too far away where people can

buy alcohol. However this shop is also right next to a cul de sac where people tend to congregate. This alley way is tight underneath the bedrooms of many flats in Trentishoe Mansions. Issuing a licence will increase traffic to a heavy footfall area. It is right next door to macdonald which also has many anti social behaviour issues which the police recognise. It will result in more crime abs disorder, more noise abs public nuisance and eventually less public safety. I oppose this application.

About this form

Issued by

Camden Town Hall
Judd Street
London
WC1H 9JE

Contact phone

020 7974 4444

Data protection

No personal information you have given us will be passed on to third parties for commercial purposes. The Council's policy is that all information will be shared among officers and other agencies where the legal framework allows it, if this will help to improve the service you receive and to develop other services. If you do not wish certain information about you to be exchanged within the Council, you can request that this does not happen.

Representation	
Premises name	London and Soho Stores
Application reference number	APP\PREMISES-NEW\105946
Last date for representation	23/08/2021

Making a representation as As an individual

Your details

First name mark

Last name quinlan

Telephone number (optional) [REDACTED]

Email address [REDACTED]

Address Flat 15 Trentishoe Mansions
90 Charing Cross Road
London
WC2H 0JE

Remain anonymous No

Grounds of representation

- prevention of crime and disorder
- prevention of public nuisance

Details of representation

I live in Trentishoe Mansions which is located immediately next door to 88 Charing Cross Road. The area outside already attracts a large amount of anti-social behaviour including drug dealing and drug taking. Adding an off-licence selling alcohol in this area is likely to add to crime and disorder in the area as well as resulting in additional public nuisance. I am really concerned about the Cumulative Impact. Sorry to sound negative but the last thing

we need is more establishments selling alcohol for takeaway. Everyone will be drinking on the street.

About this form

Issued by

Camden Town Hall
Judd Street
London
WC1H 9JE

Contact phone

020 7974 4444

Data protection

No personal information you have given us will be passed on to third parties for commercial purposes. The Council's policy is that all information will be shared among officers and other agencies where the legal framework allows it, if this will help to improve the service you receive and to develop other services. If you do not wish certain information about you to be exchanged within the Council, you can request that this does not happen.

Representation	
Premises name	London and Soho Stores
Application reference number	APP\PREMISES-NEW\105946
Last date for representation	23/08/2021

Making a representation as

As an individual

Your details**First name**

Terence

Last name

Doyle

Telephone number (optional)

[REDACTED]

Email address

[REDACTED]

Address

Flat 18 Trentishoe Mansions
90 Charing Cross Road
London
WC2H 0JE

Remain anonymous

No

Grounds of representation

- prevention of crime and disorder
- ensuring public safety
- prevention of public nuisance

Details of representation

The front doorway to my block of 23 flats is literally 3 feet away from this shop. We are already victims of passersby urinating / vomiting in the doorway and discarding litter, as well as blocking the doorway leading to danger and fear. The last thing we need in the area is yet another place selling alcohol, which will mainly appeal to people using the McDonald's next door, which has already a bad record of trouble

with the police being called. We have half a dozen shops within 100 yards where off licence drinks are freely available. Any new venue will not appeal to ordinary pedestrians, only to late night carousers. People who buy here will not be buying to take home but merely to drink in the street, adding to further disorder. We have only recently managed to get rid of a drug dealer plague. We do not want them attracted by careless street drinkers.

About this form

Issued by

Camden Town Hall
Judd Street
London
WC1H 9JE

Contact phone

020 7974 4444

Data protection

No personal information you have given us will be passed on to third parties for commercial purposes. The Council's policy is that all information will be shared among officers and other agencies where the legal framework allows it, if this will help to improve the service you receive and to develop other services. If you do not wish certain information about you to be exchanged within the Council, you can request that this does not happen.

Officers Summary of Conditions consistent with the operating schedule

1. There shall be CCTV in operation and signs will be prominently displayed.
2. All instances of crime and disorder to be reported by the designated supervisor or responsible member of staff.
3. Fire extinguishers and fire alarm is installed.
4. All alcohol shall be sold in sealed containers. They shall not be opened or consumed in or within the vicinity of the premises.
5. Where the sale of alcohol is taking place employees of the premises must request sight of evidence of the age of any person appearing to be under 25 years of age (Challenge 25).
6. The Premises will display prominent signage by every entrance and exit requesting customers to leave the premises quietly and respect local residents.

Section 1: Background comments of the Borough Solicitor

- 1.1 The purpose of Camden's Statement of Licensing Policy is to make it clear to applicants that wider considerations will be taken into account when determining applications. It is intended to guide the Licensing Panel when considering licence applications. However, the Licensing Panel must always consider each application on its own merits and allow exceptions to the normal policy where the circumstances of the application justify allowing an exception. The burden is on the applicant to show that they comply with the policy.
- 1.2 Members should only address those matters that have formed the subject matter of relevant representations. Matters that arise that are not the subject of relevant representations fall outside the function that the Panel is exercising when it holds a hearing
- 1.3 Members must determine, having regard for the evidence, whether granting the application for a premises licence will impact adversely on the policy criteria listed in paragraph 3 of this report.
- 1.4 In accordance with the provisions of Part 1 of Schedule 5 of the Act, where a Licensing Authority rejects in whole or in part, an application for a new premises licence, the applicant may appeal against the decision, to a magistrate's court within 21 days of being notified of the decision.
- 1.5 Similarly, where a person who made relevant representations in relation to the application contends that the licence ought not to have been granted, or that different or additional conditions should have been imposed on the licence, he may appeal against the decision to a magistrate's court within 21 days of being notified of the decision.
- 1.6 **The Human Rights Act 1998** incorporates the key articles of the European Convention on Human Rights into domestic law. Decisions on licensing matters are actions of a public authority and must be compatible with Convention rights. Consequently, Members of the Panel must be aware of the rights contained in the Convention (particularly those set out below) when making licensing decisions.
 - (a) **Article 6: Right to a fair trial**

In the determination of his civil rights and obligations, everyone is entitled to a fair and public hearing within a reasonable time by an independent and impartial tribunal established by law.
 - (b) **Article 8: Right to respect for private and family life**

Everyone has a right to respect for his or her private life, his home and correspondence.

(c) Article 1 of the First Protocol: Protection of property

Every natural or legal person is entitled to the peaceful enjoyment of his possessions, including a licence. No one shall be deprived of his possession except in the public interest and subject to the conditions provided for by law and by the general principles of international law.

(d) Article 10: Freedom of Expression

Everyone has the right to freedom of expression. This right shall include freedom to hold opinions and to receive and impart information and ideas without interference by public authority and regardless of frontiers. This Article shall not prevent States from requiring the licensing of broadcasting, television or cinema enterprises.

The exercise of these freedoms since it carries with it duties and responsibilities may be subject to such formalities, conditions, restrictions or penalties as are prescribed by law and are necessary in a democratic society, in the interests of national security, territorial integrity or public safety, for the prevention of disorder or crime, for the protection of health and morals, for the protection of the reputation or rights of others, for preventing the disclosure of information received in confidence, or for maintaining the authority and impartiality of the judiciary.

(e) Article 14: Prohibition of discrimination

The enjoyment of the rights and freedoms set forth in this Convention shall be secured without discrimination on any ground such as sex, race, colour, language, religion, political or other opinion, national or social origin, association with a national minority, property, birth, or other status.

- 1.7 When formulating policy local authorities must have regard to the **Equality Act 2010**. The Act provides protection from discrimination in respect of certain protected characteristics, namely: age, disability, gender reassignment, pregnancy and maternity, race, religion or beliefs and sex and sexual orientation. It places the Council under a legal duty to have due regard to the advancement of equality in the exercise of its powers including licensing powers. Members of the panel must be mindful of this duty when determining all licensing applications.

The section 149 Public Sector Equality Duty

(1) A public authority must, in the exercise of its functions, have due regard to the need to—

- (a) eliminate discrimination, harassment, victimisation and any other conduct that is prohibited by or under this Act;
- (b) advance equality of opportunity between persons who share a relevant protected characteristic and persons who do not share it;
- (c) foster good relations between persons who share a relevant protected characteristic and persons who do not share it.

(2) A person who is not a public authority but who exercises public functions must, in the exercise of those functions, have due regard to the matters mentioned in subsection (1).

(3) Having due regard to the need to advance equality of opportunity between persons who share a relevant protected characteristic and persons who do not share it involves having due regard, in particular, to the need to—

- (a) remove or minimise disadvantages suffered by persons who share a relevant protected characteristic that are connected to that characteristic;
- (b) take steps to meet the needs of persons who share a relevant protected characteristic that are different from the needs of persons who do not share it;
- (c) encourage persons who share a relevant protected characteristic to participate in public life or in any other activity in which participation by such persons is disproportionately low.

(4) The steps involved in meeting the needs of disabled persons that are different from the needs of persons who are not disabled include, in particular, steps to take account of disabled persons' disabilities.

(5) Having due regard to the need to foster good relations between persons who share a relevant protected characteristic and persons who do not share it involves having due regard, in particular, to the need to—

- (a) tackle prejudice, and
- (b) promote understanding.

(6) Compliance with the duties in this section may involve treating some persons more favourably than others; but that is not to be taken as permitting conduct that would otherwise be prohibited by or under this Act.

1.8 In determining any application, the Council must comply with the public sector equality duty in s.149 of the 2010 Act. This is a duty to have regard to the need to achieve the statutory goals of s.149, rather than to achieve a particular result. The s149 duty sits alongside and does not override statutory requirements in relation to determining licensing applications, including the duty to consider all evidence on its merits and the legislative criteria listed at paragraphs 3 & 4.

1.9 When members have before them representations or other material on issues relevant to s149, even outside the scope of “standard” licensing considerations such material must still be specifically assessed in the context of s149. However, because s149 creates a requirement to “have regard” the fact a matter raised is relevant to s149 will not automatically translate into a reason for refusing an application that would be sustainable in any subsequent appeal, given the legal requirement to determine applications in compliance with licensing legislation.

Section 2: Financial Comments

- 2.1 Following consideration there are no financial implications concerning this application. The Executive Director Corporate Services has been consulted in the preparation of this report and has no further comments to add.